

NOTICE!!

These documents have been scanned!

Do not place un-scanned documents beneath this notice!

Do not remove this notice from this file!

GPO Jacket No. 560-102
Print Order 61540
Rise Business Services, LLC
Job=AZ15 5/16/2019



Box Number= AZ15055



Claim Begin-End: AMC410881-AMC410881

1 Initial Receipt



AZ15055-2

AMC410569-AMC411560

United States Department of the Interior
Bureau of Land Management
 LANDS/RECREATION & PLANNING
 ONE N CENTRAL AVE
 PHOENIX, AZ 85004 -2203
 Phone: 602-417-9200

Receipt

No:

2433941

| | |
|--|--------------------------------------|
| Transaction #: 2509529 | |
| Date of Transaction: 09/19/2011 | |
| CUSTOMER: | |
| PAUL KLABACHA 1 LIMESTONE CT LEMONT,IL 60439-2102 US | SEP 21 2011 ENTERED INTO COMPUTER |

| LINE # | QTY | DESCRIPTION | REMARKS | UNIT PRICE | TOTAL |
|---------------|------|--|---------|------------|-----------------|
| 1 | 1.00 | LOCATABLE MINERALS / MINING CLAIMS- NEW,UNADJUD, ONE OR MORE AUTH NOS / NEW MINING CLAIM PROCESSING FEE \$15 CASES: AMC410881/\$15.00 | | - n/a - | 15.00 |
| 2 | 1.00 | LOCATABLE MINERALS / MINING CLAIMS- NEW,UNADJUD, ONE OR MORE AUTH NOS / NEW MINING CLAIM LOCATION FEE \$34 CASES: AMC410881/\$34.00 | | - n/a - | 34.00 |
| 3 | 1.00 | LOCATABLE MINERALS / MINING CLAIMS- NEW,UNADJUD, ONE OR MORE AUTH NOS / NEW MINING CLAIM MAINT FEE \$140 CASES: AMC410881/\$140.00 | | - n/a - | 140.00 |
| TOTAL: | | | | | \$189.00 |

| PAYMENT INFORMATION | | | |
|---------------------|-----------|---|----------------------|
| 1 | AMOUNT: | 189.00 | POSTMARKED: N/A |
| | TYPE: | CHECK | RECEIVED: 09/19/2011 |
| | CHECK NO: | 2830 | |
| | NAME: | CLAYBACK DEVELOPMENT 1 LIMESTONE CT LEMONT IL 60439-2102 US | |

| |
|---------|
| REMARKS |
| |

This receipt was generated by the automated BLM Collections and Billing System and is a paper representation of a portion of the official electronic record contained therein.

NOTICE!!

These documents have been scanned!

Do not place un-scanned documents beneath this notice!

Do not remove this notice from this file!

GPO Jacket No. 560-102
Print Order 61540
Rise Business Services, LLC
Job=AZ15 5/16/2019



Box Number= AZ15055



Claim Begin-End: AMC410881-AMC410881

2 Correspondence



AZ15055-2 AMC410569-AMC411560

**NO
DOCUMENTS
FOUND**

NO DOCUMENTS FOUND
NO DOCUMENTS FOUND

NOTICE!!

These documents have been scanned!

Do not place un-scanned documents beneath this notice!

Do not remove this notice from this file!

GPO Jacket No. 560-102
Print Order 61540
Rise Business Services, LLC
Job=AZ15 5/16/2019



Box Number= AZ15055



Claim Begin-End: AMC410881-AMC410881

3 Transfers



AZ15055-2

AMC410569-AMC411560

**NO
DOCUMENTS
FOUND**

NO DOCUMENTS FOUND
NO DOCUMENTS FOUND

NOTICE!!

These documents have been scanned!

Do not place un-scanned documents beneath this notice!

Do not remove this notice from this file!

GPO Jacket No. 560-102
Print Order 61540
Rise Business Services, LLC
Job=AZ15 5/16/2019



Box Number= AZ15055



Claim Begin-End: AMC410881-AMC410881

4 Miscellaneous



AZ15055-2

AMC410569-AMC411560

**NO
DOCUMENTS
FOUND**

NO DOCUMENTS FOUND
NO DOCUMENTS FOUND

NOTICE!!

These documents have been scanned!

Do not place un-scanned documents beneath this notice!

Do not remove this notice from this file!

GPO Jacket No. 560-102
Print Order 61540
Rise Business Services, LLC
Job=AZ15 5/16/2019



Box Number= AZ15055



Claim Begin-End: AMC410881-AMC410881

5 Annual Filings



AZ15055-2

AMC410569-AMC411560

UNITED STATES
DEPARTMENT OF THE INTERIOR
BUREAU OF LAND MANAGEMENT

444
[Handwritten initials]

410881
411023

MAINTENANCE FEE WAIVER CERTIFICATION

FORM APPROVED
OMB NO. 1004-0114
Expires: January 31, 2020

SEE INSTRUCTIONS ON PAGE 2

1. This small miner waiver is filed for the assessment year beginning on September 1, 2019 and ending on September 1, 2020.
2. The undersigned and all related parties owned ten or fewer mining claims, mill, or tunnel sites located and maintained on Federal lands in the United States of America on September 1, 2017.
3. The undersigned have performed the assessment work required by law for each mining claim listed prior to filing this waiver and understand that by filing this form, the undersigned must file an affidavit of assessment work with the Bureau of Land Management (BLM) by the December 30th following the filing of this waiver.
4. The undersigned understand that if the assessment work obligation has not yet come due under 30 U.S.C. 28 (for those claims in their first assessment year only), a notice of intent to hold reciting this condition must be recorded by the December 30th following the filing of this waiver.
5. The undersigned understand that mill and tunnel sites may also be listed on this waiver and be waived from payment of the maintenance fee, and that a notice of intent to hold for these sites is required to be filed with the BLM by the December 30th following the filing of this waiver.
6. The undersigned understand and acknowledge that pursuant to 43 U.S.C. 1212 and 18 U.S.C. 1001, the filing or recording of a false, fictitious, or fraudulent document with the BLM may result in a fine of up to \$250,000, a prison term not to exceed five years, or both.
7. The mining claims, mill or tunnel sites for which this waiver from payment of the maintenance fees is requested are:

| CLAIM OR SITE NAME | BLM RECORDATION SERIAL NUMBER |
|--------------------|-------------------------------|
| 1. SILVERSTONE ✓ | 410881 |
| 2. SILVERSTONE 1 | 411023 |
| 3. SILVERSTONE 2 | 411024 |
| 4. SILVERSTONE 3 | 411025 |
| 5. SILVERSTONE 4 | 411026 |
| 6. SILVERSTONE 5 | 411027 |
| 7. SILVERSTONE 6 | 411028 |
| 8. SILVERSTONE 7 | 411029 |
| 9. | |
| 10. | |

RECEIVED
BLM STATE OFFICE
2019 SEP -3 A 8:39
PHOENIX, ARIZONA

The owner(s) (claimants) of the above mining claims and sites are:

PAUL KLABACHA
(Owner's Name - Please Print)
1 LIMESTONE COURT
(Owner's Mailing Address)

Paul Klabacha
(Owner's Signature)
LEMONT IL 60439
(City) (State) (Zip Code)

OCKINC@ATT.NET EMAIL
(Owner's Name - Please Print)
312 316-7224 PHONE
(Owner's Mailing Address)

(Owner's Signature)

(City) (State) (Zip Code)

(Owner's Name - Please Print)

(Owner's Mailing Address)

(Owner's Signature)

(City) (State) (Zip Code)

(Owner's Name - Please Print)

(Owner's Mailing Address)

(Owner's Signature)

(City) (State) (Zip Code)

(Continued on page 2)

SEP 16 2019
BY: [Signature]

455 2596

WU

| | | | |
|-------------------------------|---------------------|---------|------------|
| (Owner's Name - Please Print) | (Owner's Signature) | | |
| (Owner's Mailing Address) | (City) | (State) | (Zip Code) |
| | | | |
| (Owner's Name - Please Print) | (Owner's Signature) | | |
| (Owner's Mailing Address) | (City) | (State) | (Zip Code) |
| | | | |
| (Owner's Name - Please Print) | (Owner's Signature) | | |
| (Owner's Mailing Address) | (City) | (State) | (Zip Code) |
| | | | |
| (Owner's Name - Please Print) | (Owner's Signature) | | |
| (Owner's Mailing Address) | (City) | (State) | (Zip Code) |

18 U.S.C. 1001 and 43 U.S.C. 1212 make it a crime for any person knowingly and willfully to make to any department or agency of the United States any false, fictitious or fraudulent statements or representations as to any matter within its jurisdiction.

INSTRUCTIONS

1. This certification is made under the provisions of 43 U.S.C. § 1744 and 30 U.S.C. §28-28k and the regulations thereunder (43 CFR Part 3830).
2. The claimant(s) must fill in the dates in paragraph 1 for the beginning and ending of the assessment year for which this waiver is sought.
3. The claimant(s) must fill in the date in paragraph 2 for the beginning of the assessment year for which this waiver is sought.
4. All claim and site names and BLM serial numbers must be listed for the mining claims, mill sites, and tunnel sites for which the waiver is sought.
5. All owners of the mining claims, mill sites, and tunnel sites and their addresses must be given.
6. This waiver form must be signed by all the claimants or their designated agent, in original form. If an agent is designated, a notarized designation of agent, signed by all of the claimants with proper address given, must be submitted with this waiver.
7. This form must be filed no later than September 1st for the upcoming assessment year in the BLM State Office where the mining claims or sites are recorded, or the waiver cannot be granted by the BLM. (Example: To obtain a waiver for the assessment year 2012, which begins on September 1, 2011, you must qualify for and file for a waiver no later than September 1, 2011, in the proper BLM State Office.)
8. For all mining claims which require assessment work, you must record an affidavit of labor on or before the December 30th immediately following the filing of this waiver. For all other mining claims or sites waived, you must record a notice of intent to hold on or before the December 30th immediately following the filing of this waiver.
9. Mill and tunnel sites may also be listed on this waiver and be waived from payment of the maintenance fee. A notice of intent to hold for these sites is required to be filed by the December 30th following the filing of this waiver.

FOR OFFICIAL USE ONLY

UNITED STATES
DEPARTMENT OF THE INTERIOR
BUREAU OF LAND MANAGEMENT

FORM APPROVED
OMB NO.: 1004-0114
Expires: October 31, 2016

AFFIDAVIT OF ANNUAL ASSESSMENT WORK

410881

411023

WHEN RECORDED, MAIL DOCUMENT TO:

NAME: PAUL KLABACHA

ADDRESS: 1 LIMBSTONE COURT

CITY, STATE, ZIP: LEMONT, IL. 60439

FOR COUNTY RECORDER'S USE

No. of Claims 8
x \$10/claim
Total due BLM \$ 80.00

TO ALL WHOM IT MAY CONCERN:

1. The undersigned certifies that at least \$100 per claim was expended for development, labor and improvements, or equivalent value added, as the annual assessment work for the assessment year ending September 1, 2018 for the following contiguous unpatented mining claim(s), located in the County of YAVAPAI, in the State of ARIZONA.

RECEIVED
BLM
OFFICE
2018 AUG 21 P 1:39
PHOENIX ARIZONA

| BLM Serial No. | Name of Claim | Tp | Rg | Sec | Mer | County Recorder's Book and Page No. | Date |
|----------------|---------------|----------------|---------------|-----|-----|-------------------------------------|------|
| 410881 | SILVERSTONE | 11N | 1W | 2 | | B4882 P905 | 2011 |
| 411023 | SILVERSTONE 1 | 11N | 1W | 2 | | B4882 P906 | 2011 |
| 411024 | SILVERSTONE 2 | 11N | 1W | 2 | | B4882 P907 | 2011 |
| 411025 | SILVERSTONE 3 | 11N | 1W | 2 | | B4882 P908 | 2011 |
| 411026 | SILVERSTONE 4 | 11N | 1W | 2 | | B4882 P909 | 2011 |
| 411027 | SILVERSTONE 5 | 11N | 1W | 2 | | B4882 P910 | 2011 |
| 411028 | SILVERSTONE 6 | 11N | 1W | 2 | | B4882 P911 | 2011 |
| 411029 | SILVERSTONE 7 | 11N | 1W | 2 | | B4882 P912 | 2011 |
| | | 11N | 1W | 2 | | | |

#4242908

(Continued on page 2)

ENTERED
AUG 28 2018
BY: RAM

2. Type of labor and improvements (specify what was done and give the total value for that labor and improvement to show at least \$100 for each claim). If a geological, geochemical, or geophysical survey was performed, as per 30 U.S.C. 28-1, reference the title of the report of survey, give cost and date of the survey and report, and indicate it was filed with the County Recorder:

| Description of Work Performed | Value of Work Performed | Date Work Was Performed |
|-------------------------------|-------------------------|-------------------------|
| SERIES ROAD WORK AFTER FIRES, | 1,000 | 6-20-2018 |
| GRADING BRUSH CUTTING | | |
| PANNING AND DETECTING | | |
| | | |

3. Name and mailing address of each person who performed the labor and improvements:

Name (please print)

Current Mailing Address (please print)

PAUL KLABACNA

1 LIMESTONE CT.
LEMONT, IL, 60439

4. Name and mailing address of each person who holds and claims the subject mining claim(s) for the valuable minerals contained therein. Be sure to indicate if there is a change of address:

Name (please print)

Current Mailing Address (please print)

PAUL KLABACNA

1 LIMESTONE COURT
LEMONT, IL, 60439

RECEIVED
 BLM ARIZONA STATE OFFICE
 2018 AUG 21 P 1:39
 PHOENIX, ARIZONA

5. The undersigned testifies that on the date of 6-15, 2018, all monuments required by law were erected upon the subject claim(s), and all notices required by law were posted on the subject claim(s) or copies thereof were in place, and at said date, each corner monument bore or contained

markings sufficient to appropriately designate the corner of the claim to which it pertains and the name of the claim(s).

I hereby certify under penalty of perjury under the laws of the State of ARIZONA that the foregoing statements are true and correct:

Paul Klabach Date: 8-15-2018
(Signature of person responsible for above statement)

Title 18 U.S.C. 1001 and 43 U.S.C. 1212 make it a crime for any person knowingly and willfully to make to any department or agency of the United States any false, fictitious or fraudulent statements or representations as to any matter within its jurisdiction.

Notary Block

SUBSCRIBED AND SWORN TO before me, this 15th day of August 2018

By: Paul T KLABACH
(Signature of Affiant)

Title: Claudia C Rocio Clerk

My Commission Expires: 01/30/2022



INSTRUCTIONS

- 1. This is an optional form that may be used to satisfy the requirements for the Bureau of Land Management (BLM) under the provisions of 43 U.S.C. §1744 and 30 U.S.C. §28-28d and the regulations thereunder (43 CFR part 3835). Since local and State laws may vary, you should contact your local and State agencies where the claims are located to ensure all applicable laws and requirements are satisfied.
- 2. The claimant(s) must fill in the date in paragraph 1 for the applicable assessment year and the county and state where the claims are located.
- 3. All claim names, BLM serial numbers, legal descriptions, and original county recording information must be listed for the claims pertaining to this assessment notice.
- 4. The claimant(s) must complete paragraph 2 listing all labor or improvements which was performed on or did benefit the subject mining claims. The value and date of the labor or improvements must also be listed. The total amount of labor or improvements can be listed, but the total expenditure must equal at least \$100 for each claim.
- 5. The names and current mailing addresses of the person(s) performing the labor shall be listed in paragraph 3.
- 6. The name and current mailing address of each owner (claimant) of the claims shall be listed in paragraph 4. The mailing address shall be the owner's address and not the address of an agent or anyone representing the claimant. Be sure to note if there has been a change of address.
- 7. Paragraph 5 shall be completed to show the date it was verified that all monuments required by law were properly erected, all notices were posted, and that corners were appropriately designated for all claims listed.
- 8. An exact legible reproduction or duplicate (other than microfilm or other electronic media) of this affidavit or another type of affidavit of assessment work that you file or will file in the county where each claim is located, must be filed with the BLM on or before December 30 of the calendar year in which the assessment year ends. For mill or tunnel sites, a separate notice of intent to hold must be filed with the BLM on or before December 30. Requirements for filing a notice of intent to hold can be found at 43 CFR 3835.33.
- 9. A processing fee of \$10 for each claim listed must be remitted to the BLM along with this or any other affidavit of assessment work.

RECEIVED
STATE OFFICE
SEP 21 P 1:39
TUCSON ARIZONA

CLAYBACK DEVELOPMENT, LLC

1 LIMESTONE CT • LEMONT, IL 60439



BLM
ONE NORTH CENTRAL
PHOENIX, AZ.

85004-4427

S SUBURBAN IL 604

15 AUG 2018 17:11



PHOENIX, ARIZONA

2018 AUG 21 P 1:39

RECEIVED
BLM AT STATE OFFICE

85004-442700
MINING CLAIMS RENEWAL

CLAYBACK DEVELOPMENT, LLC

1 LIMESTONE CT • LEMONT, IL 60439



BLM

ONE NORTH CENTRAL
PHOENIX, AZ.

85004-4427

S SUBURBAN IL 604

25 AUG 2019 17:44

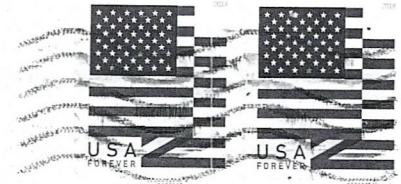

PHOENIX, ARIZONA

2018 AUG 21 P 1:39

RECEIVED
BLM AIR STAFF OFFICE

85004-442700
MINING CLAIMS RENEWAL

United States Department of the Interior
Bureau of Land Management
 DIV OF LANDS, MINRLS & ENERGY
 ONE N CENTRAL AVE
 PHOENIX, AZ 85004 -4427
 Phone: 602-417-9200

Receipt

No: 4242908

| | |
|--|--|
| Transaction #: 4358339 | |
| Date of Transaction: 08/23/2018 | |
| CUSTOMER: | |
| PAUL KLABACHA 1 LIMESTONE CT LEMONT,IL 60439-2102 US | |

| LINE # | QTY | DESCRIPTION | REMARKS | UNIT PRICE | TOTAL |
|---------------|------|--|----------------|------------|----------------|
| 1 | 1.00 | LOCATABLE MINERALS / MINING CLAIMS- NOT NEW-UNADJUD, ONE AUTH NO. ONLY / MINING CLAIM MONEY RECEIVED CASES: AMC410881/\$80.00 | POL 2018/8 WAV | - n/a - | 80.00 |
| TOTAL: | | | | | \$80.00 |

| PAYMENT INFORMATION | | | | | |
|---------------------|-----------|---|-------------|------------|--|
| 1 | AMOUNT: | 80.00 | POSTMARKED: | N/A | |
| | TYPE: | CHECK | RECEIVED: | 08/21/2018 | |
| | CHECK NO: | 4025 | | | |
| | NAME: | CLAYBACK DEVELOPMENT 1 LIMESTONE CT LEMONT IL 60439-2102 US | | | |

| |
|--|
| REMARKS |
| WAIVER HAS EXPIRED/PLEASE FILL OUT A CURRENT ONE AND RETURN ASAP |

This receipt was generated by the automated BLM Collections and Billing System and is a paper representation of a portion of the official electronic record contained therein.

UNITED STATES
DEPARTMENT OF THE INTERIOR
BUREAU OF LAND MANAGEMENT

MAINTENANCE FEE WAIVER CERTIFICATION

SEE INSTRUCTIONS ON PAGE 2

Filed to # 39
[Signature]

410881
411023

FORM APPROVED
OMB NO. 1004-0114
Expires: January 31, 2020

- This small miner waiver is filed for the assessment year beginning on September 1, 2018 and ending on September 1, 2019.
- The undersigned and all related parties owned ten or fewer mining claims, mill, or tunnel sites located and maintained on Federal lands in the United States of America on September 1, 2011.
- The undersigned have performed the assessment work required by law for each mining claim listed prior to filing this waiver and understand that by filing this form, the undersigned must file an affidavit of assessment work with the Bureau of Land Management (BLM) by the December 30th following the filing of this waiver.
- The undersigned understand that if the assessment work obligation has not yet come due under 30 U.S.C. 28 (for those claims in their first assessment year only), a notice of intent to hold reciting this condition must be recorded by the December 30th following the filing of this waiver.
- The undersigned understand that mill and tunnel sites may also be listed on this waiver and be waived from payment of the maintenance fee, and that a notice of intent to hold for these sites is required to be filed with the BLM by the December 30th following the filing of this waiver.
- The undersigned understand and acknowledge that pursuant to 43 U.S.C. 1212 and 18 U.S.C. 1001, the filing or recording of a false, fictitious, or fraudulent document with the BLM may result in a fine of up to \$250,000, a prison term not to exceed five years, or both.
- The mining claims, mill or tunnel sites for which this waiver from payment of the maintenance fees is requested are:

| CLAIM OR SITE NAME | BLM RECORDATION SERIAL NUMBER |
|--------------------|-------------------------------|
| 1. SILVERSTONE | 410881 |
| 2. SILVERSTONE 1 | 411023 |
| 3. SILVERSTONE 2 | 411024 |
| 4. SILVERSTONE 3 | 411025 |
| 5. SILVERSTONE 4 | 411026 |
| 6. SILVERSTONE 5 | 411027 |
| 7. SILVERSTONE 6 | 411028 |
| 8. SILVERSTONE 7 | 411029 |
| 9. | |
| 10. | |

RECEIVED
BLM AZ STATE OFFICE
2018 SEP -6 P 2:09
PHOENIX, ARIZONA

The owner(s) (claimants) of the above mining claims and sites are:

PAUL KLABACHA
(Owner's Name - Please Print)
1 LIMESTONE COURT
(Owner's Mailing Address)

[Signature]
(Owner's Signature)
LEMONT IL 60439
(City) (State) (Zip Code)

OCK INC @ ATT.NET (EMAIL)
(Owner's Name - Please Print)
312 316-7224 (PHONE)
(Owner's Mailing Address)

(Owner's Signature)
(City) (State) (Zip Code)

(Owner's Name - Please Print)
(Owner's Mailing Address)

(Owner's Signature)
(City) (State) (Zip Code)

(Owner's Name - Please Print)
(Owner's Mailing Address)

(Owner's Signature)
(State) (Zip Code)

(Continued on page 2)

ENTERED
SEP 14 2018 (ty)
BY: BDS

| | | | |
|--|------------------------------|------------------|---------------------|
| _____ (Owner's Name - Please Print) | _____ (Owner's Signature) | | |
| _____ (Owner's Mailing Address) | _____ (City) | _____ (State) | _____ (Zip Code) |
| ----- | | | |
| _____ (Owner's Name - Please Print) | _____ (Owner's Signature) | | |
| _____ (Owner's Mailing Address) | _____ (City) | _____ (State) | _____ (Zip Code) |
| ----- | | | |
| _____ (Owner's Name - Please Print) | _____ (Owner's Signature) | | |
| _____ (Owner's Mailing Address) | _____ (City) | _____ (State) | _____ (Zip Code) |
| ----- | | | |
| _____ (Owner's Name - Please Print) | _____ (Owner's Signature) | | |
| _____ (Owner's Mailing Address) | _____ (City) | _____ (State) | _____ (Zip Code) |

18 U.S.C. 1001 and 43 U.S.C. 1212 make it a crime for any person knowingly and willfully to make to any department or agency of the United States any false, fictitious or fraudulent statements or representations as to any matter within its jurisdiction.

INSTRUCTIONS

1. This certification is made under the provisions of 43 U.S.C. § 1744 and 30 U.S.C. §28-28k and the regulations thereunder (43 CFR Part 3830)
2. The claimant(s) must fill in the dates in paragraph 1 for the beginning and ending of the assessment year for which this waiver is sought.
3. The claimant(s) must fill in the date in paragraph 2 for the beginning of the assessment year for which this waiver is sought.
4. All claim and site names and BLM serial numbers must be listed for the mining claims, mill sites, and tunnel sites for which the waiver is sought.
5. All owners of the mining claims, mill sites, and tunnel sites and their addresses must be given.
6. This waiver form must be signed by all the claimants or their designated agent, in original form. If an agent is designated, a notarized designation of agent, signed by all of the claimants with proper address given, must be submitted with this waiver.
7. This form must be filed no later than September 1st for the upcoming assessment year in the BLM State Office where the mining claims or sites are recorded, or the waiver cannot be granted by the BLM. (Example: To obtain a waiver for the assessment year 2012, which begins on September 1, 2011, you must qualify for and file for a waiver no later than September 1, 2011, in the proper BLM State Office.)
8. For all mining claims which require assessment work, you must record an affidavit of labor on or before the December 30th immediately following the filing of this waiver. For all other mining claims or sites waived, you must record a notice of intent to hold on or before the December 30th immediately following the filing of this waiver.
9. Mill and tunnel sites may also be listed on this waiver and be waived from payment of the maintenance fee. A notice of intent to hold for these sites is required to be filed by the December 30th following the filing of this waiver.

FOR OFFICIAL USE ONLY

PRIORITY[®]
★ MAIL ★

FLAT RATE ENVELOPE

ONE RATE ★ ANY WEIGHT*

APPLY PRIORITY MAIL POSTAGE HERE

U.S. POSTAGE PAID
P.M. 2-Day
LEMONTT, IL
60439
SEP 04 18
AMOUNT
\$6.20
R2304H109239-07

RECEIVED
BLM AZ STATE OFFICE

2018 SEP -6 P 2:09

PHOENIX, ARIZONA

EXPECTED DELIVERY DAY: 09/06/2018

USPS TRACKING NUMBER



* For international shipments, the maximum weight is 70 ounces.

EP14H July 2013 Outer Dimension: 10 x 5

* Domestic only.

TATES
SERVICE®

TRACKED

INSURED

This product is for use with Priority Mail.®
Misuse may be a violation of federal law.
This label is not for resale.

PRESS HERE TO SEAL



EP14H July 2013
OD: 10 x 5



500001000064

VISIT US AT USPS.COM®
Label 106A, Jan 2015



PRIORITY®
★ **MAIL** ★

This product is for use with Priority Mail.®
Misuse may be a violation of federal law.
This label is not for resale.

FLAT RATE ENVELOPE
ONE RATE ★ ANY WEIGHT

VISIT US AT U
Label 106A, Jan

PRIORITY®
★ **MAIL** ★

1004



85004



DATE OF DELIVERY SPECIFIED *

USPS TRACKING™ INCLUDED *

INSURANCE INCLUDED *

PICKUP AVAILABLE



* Domestic only



9505 5134 8771 8247 1781 63

This packaging is the property of the U.S. Postal Service® and is provided solely for use in sending Priority Mail® shipments. Misuse may be a violation of federal law. This packaging is not for resale.

CLAYBACK DEVELOPMENT, LLC

1 LIMESTONE CT • LEMONT, IL 60439



BLM
ONE NORTH CENTRAL AVE.
SUITE 800
PHOENIX, AZ. 85004-4427

ATTN: SUZIE CRUZE



RECEIVED
BLM AZ STATE OFFICE

2019 SEP - 6 P 2:09

PHOENIX, ARIZONA

**CLAYBACK
DEVELOPMENT, LLC**

1 LIMESTONE CT • LEMONT, IL 60439



BLM
ONE NORTH CENTRAL AVE.
SUITE 800
PHOENIX, AZ. 85004-4427

ATTN: SUZIE CRUZE

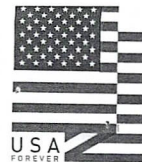

RECEIVED
BLM AZ STATE OFFICE
2010 SEP -6 P 2:09
PHOENIX, ARIZONA

PRIORITY®
★ MAIL ★

FLAT RATE ENVELOPE
ONE RATE ★ ANY WEIGHT*

APPLY PRIORITY MAIL POSTAGE HERE

U.S. POSTAGE PAID
PM 2 Day
LEMON, IL
60439
SEP 04 18
AMOUNT
\$6.20
R2304H109239-07

RECEIVED
BLM AZ STATE OFFICE

2018 SEP -6 P 2:09

PHOENIX, ARIZONA

EXPECTED DELIVERY DAY: 09/06/2018

USPS TRACKING NUMBER



* For international shipments, the maximum weight is 70 lbs.

EP14H July 2013 Outer Dimension: 10 x 5

UNITED STATES
DEPARTMENT OF THE INTERIOR
BUREAU OF LAND MANAGEMENT

392
[Handwritten signature]

410881
411023

MAINTENANCE FEE WAIVER CERTIFICATION

FORM APPROVED
OMB NO. 1004-0114

Expires: October 31, 2016

SEE INSTRUCTIONS ON PAGE 2

- This small miner waiver is filed for the assessment year beginning on September 1, 2018 and ending on September 1, 2019.
- The undersigned and all related parties owned ten or fewer mining claims, mill, or tunnel sites located and maintained on Federal lands in the United States of America on September 1, 2011.
- The undersigned have performed the assessment work required by law for each mining claim listed prior to filing this waiver and understand that by filing this form, the undersigned must file an affidavit of assessment work with the Bureau of Land Management (BLM) by the December 30th following the filing of this waiver.
- The undersigned understand that if the assessment work obligation has not yet come due under 30 U.S.C. 28 (for those claims in their first assessment year only), a notice of intent to hold reciting this condition must be recorded by the December 30th following the filing of this waiver.
- The undersigned understand that mill and tunnel sites may also be listed on this waiver and be waived from payment of the maintenance fee, and that a notice of intent to hold for these sites is required to be filed with the BLM by the December 30th following the filing of this waiver.
- The undersigned understand and acknowledge that pursuant to 43 U.S.C. 1212 and 18 U.S.C. 1001, the filing or recording of a false, fictitious, or fraudulent document with the BLM may result in a fine of up to \$250,000, a prison term not to exceed five years, or both.
- The mining claims, mill or tunnel sites for which this waiver from payment of the maintenance fees is requested are:

| CLAIM OR SITE NAME | BLM RECORDATION SERIAL NUMBER |
|--------------------|-------------------------------|
| 1. SILVERSTONE | 410881 (913) |
| 2. SILVERSTONE 1 | 411023 |
| 3. SILVERSTONE 2 | 411024 |
| 4. SILVERSTONE 3 | 411025 |
| 5. SILVERSTONE 4 | 411026 |
| 6. SILVERSTONE 5 | 411027 |
| 7. SILVERSTONE 6 | 411028 |
| 8. SILVERSTONE 7 | 411029 |
| 9. | |
| 10. | |

The owner(s) (claimants) of the above mining claims and sites are:

PAUL KLABACHA
(Owner's Name - Please Print)
1 LIMESTONE CT.
(Owner's Mailing Address)

Paul Klabacha
(Owner's Signature)
LEMONT IL 60439
(City) (State) (Zip Code)

OCKINC@ATT.NET GMAIL
(Owner's Name - Please Print)
312 316-7224 PHONE
(Owner's Mailing Address)

(Owner's Signature)
(City) (State) (Zip Code)

(Owner's Name - Please Print)

(Owner's Mailing Address)

(Owner's Signature)
(City) (State) (Zip Code)

(Owner's Name - Please Print)

(Owner's Mailing Address)

(Owner's Signature)
(City) (State) (Zip Code)

(Continued on page 2)

RECEIVED
 BLM AZ STATE OFFICE
 2018 AUG 21 PM 1:29
 PHOENIX, ARIZONA

#4242908

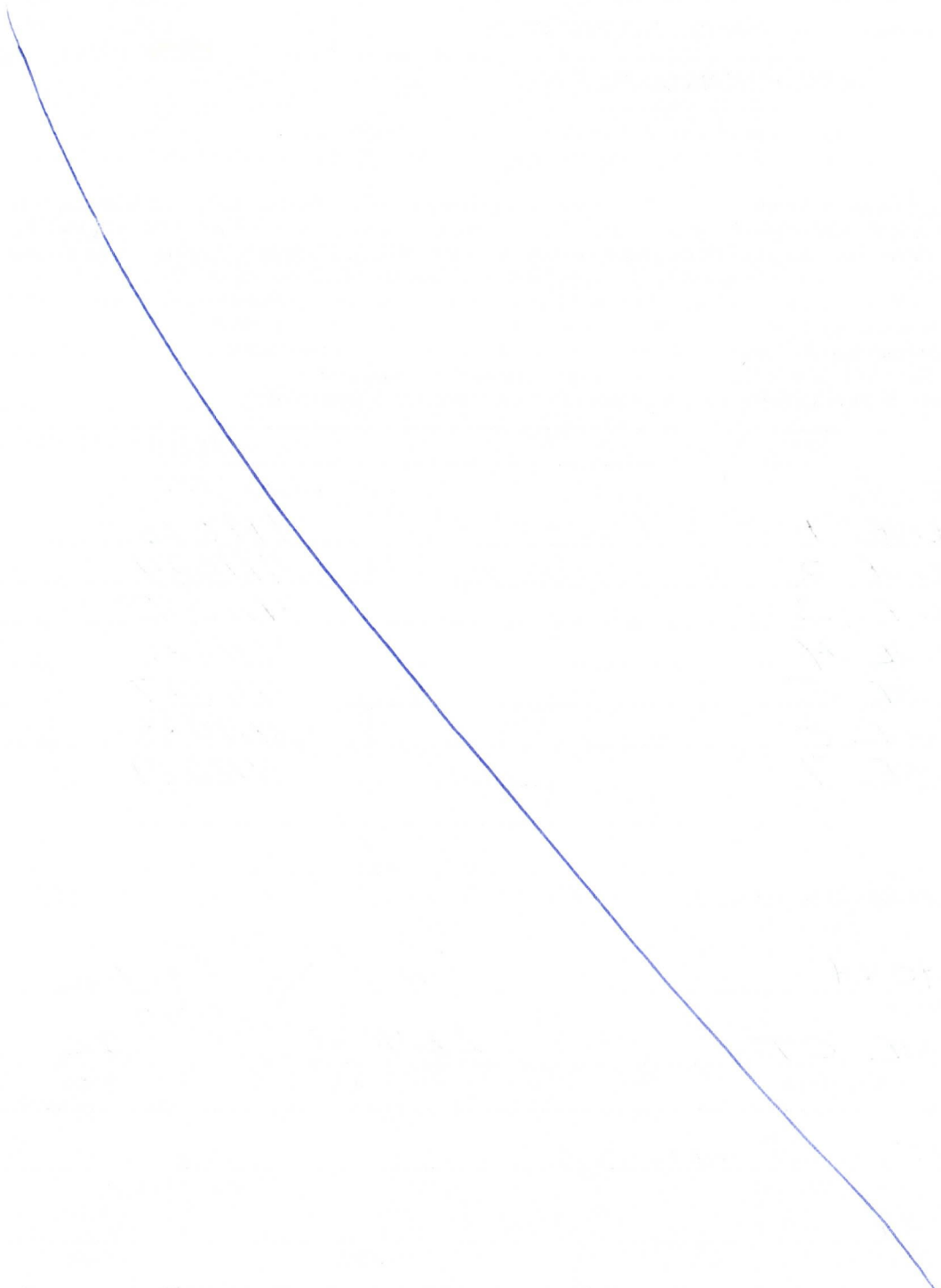

YER 1985 10 11 3d

11/11/85

UNITED STATES
DEPARTMENT OF THE INTERIOR
BUREAU OF LAND MANAGEMENT
MAINTENANCE FEE WAIVER CERTIFICATION

JMK

432

Amc410881
411023

FORM APPROVED
OMB NO. 1004-0114
Expires: October 31, 2016

SEE INSTRUCTIONS ON PAGE 2

- This small miner waiver is filed for the assessment year beginning on September 1, 2017 and ending on September 1, 2018.
- The undersigned and all related parties owned ten or fewer mining claims, mill, or tunnel sites located and maintained on Federal lands in the United States of America on September 1, 2017.
- The undersigned have performed the assessment work required by law for each mining claim listed prior to filing this waiver and understand that by filing this form, the undersigned must file an affidavit of assessment work with the Bureau of Land Management (BLM) by the December 30th following the filing of this waiver.
- The undersigned understand that if the assessment work obligation has not yet come due under 30 U.S.C. 28 (for those claims in their first assessment year only), a notice of intent to hold reciting this condition must be recorded by the December 30th following the filing of this waiver.
- The undersigned understand that mill and tunnel sites may also be listed on this waiver and be waived from payment of the maintenance fee, and that a notice of intent to hold for these sites is required to be filed with the BLM by the December 30th following the filing of this waiver.
- The undersigned understand and acknowledge that pursuant to 43 U.S.C. 1212 and 18 U.S.C. 1001, the filing or recording of a false, fictitious, or fraudulent document with the BLM may result in a fine of up to \$250,000, a prison term not to exceed five years, or both.
- The mining claims, mill or tunnel sites for which this waiver from payment of the maintenance fees is requested are:

| CLAIM OR SITE NAME | BLM RECORDATION SERIAL NUMBER |
|--------------------|-------------------------------|
| 1. SILVERSTONE | ✓ 410881 |
| 2. SILVERSTONE 1 | 411023 |
| 3. SILVERSTONE 2 | 411024 |
| 4. SILVERSTONE 3 | 411025 |
| 5. SILVERSTONE 4 | 411026 |
| 6. SILVERSTONE 5 | 411027 |
| 7. SILVERSTONE 6 | 411028 |
| 8. SILVERSTONE 7 | 411029 |
| 9. | |
| 10. | |

RECEIVED
BLM AZ STATE OFFICE
2017 SEP - 1 P 3:07
PHOENIX, ARIZONA

The owner(s) (claimants) of the above mining claims and sites are:

PAUL KLABACHA
(Owner's Name - Please Print)

1 LIMESTONE COURT
(Owner's Mailing Address)

Paul Klabacha
(Owner's Signature)

LEMONT IL 60439
(City) (State) (Zip Code)

OCKING @ ATT. NET (EMAIL)
(Owner's Name - Please Print)

312 316-7224 (CELLPHONE)
(Owner's Mailing Address)

(Owner's Signature)

(City) (State) (Zip Code)

(Owner's Name - Please Print)

483
(Owner's Mailing Address)

(Owner's Signature)

(City) (State) (Zip Code)

(Owner's Name - Please Print)

(Owner's Mailing Address)

(Owner's Signature)

(City) (State) (Zip Code)

INTERESTED
SEP 13 2017
BY: *[Signature]*

#3971331

mm

AFFIDAVIT OF ANNUAL ASSESSMENT WORK

Amc 410881
Amc 411023

WHEN RECORDED, MAIL DOCUMENT TO:

NAME: PAUL KLABACKA

ADDRESS: 1 LIMESTONE COURT

CITY, STATE, ZIP: LEMONT, IL. 60439

FOR COUNTY RECORDER'S USE

No. of Claims 8
x \$10/claim
Total due BLM \$ 80.00

TO ALL WHOM IT MAY CONCERN:

1. The undersigned certifies that at least \$100 per claim was expended for development, labor and improvements, or equivalent value added, as the annual assessment work for the assessment year ending September 1, 2017 for the following contiguous unpatented mining claim(s), located in the County of YAVAPAI, in the State of ARIZONA.

| BLM Serial No. | Name of Claim | Tp | Rg | Sec | Mer | County Recordation Book and Page No. | Date |
|----------------|---------------|-----|----|-----|-----|--------------------------------------|------|
| 410881 | SILVERSTONE | 11N | 1W | 2 | | B4882 P905 | 2011 |
| 411023 | SILVERSTONE 1 | 11N | 1W | 2 | | B4882 P906 | 2011 |
| 411024 | SILVERSTONE 2 | 11N | 1W | 2 | | B4882 P907 | 2011 |
| 411025 | SILVERSTONE 3 | 11N | 1W | 2 | | B4882 P908 | 2011 |
| 411026 | SILVERSTONE 4 | 11N | 1W | 2 | | B4882 P909 | 2011 |
| 411027 | SILVERSTONE 5 | 11N | 1W | 2 | | B4882 P910 | 2011 |
| 411028 | SILVERSTONE 6 | 11N | 1W | 2 | | B4882 P911 | 2011 |
| 411029 | SILVERSTONE 7 | 11N | 1W | 2 | | B4882 P912 | 2011 |
| | | | | | | | |
| | | | | | | | |

RECEIVED
BLM AZ STATE OFFICE
PHOENIX, ARIZONA
2011 SEP - 1 P 3:01

AT 9/15/17

2. Type of labor and improvements (specify what was done and give the total value for that labor and improvement to show at least \$100 for each claim). If a geological, geochemical, or geophysical survey was performed, as per 30 U.S.C. 28-1, reference the title of the report of survey, give cost and date of the survey and report, and indicate it was filed with the County Recorder:

| Description of Work Performed | Value of Work Performed | Date Work Was Performed |
|-------------------------------|-------------------------|-------------------------|
| ROAD/TRAIL IMPROVEMENTS | \$ 1,000.00 | 6-15-2017 |
| GRADING | | |
| BRUSH CUTTING | | |
| PANNING AND DETECTING | | |
| | | |

3. Name and mailing address of each person who performed the labor and improvements:

Name (please print)

Current Mailing Address (please print)

PAUL KLABAENA

1 LIMESTONE CT.
LEMONST, IL. 60439

4. Name and mailing address of each person who holds and claims the subject mining claim(s) for the valuable minerals contained therein. Be sure to indicate if there is a change of address:

Name (please print)

Current Mailing Address (please print)

PAUL KLABAENA

1 LIMESTONE COURT
LEMONST, IL. 60439
OCKINC@ATT.NET
312 316-7224

5. The undersigned testifies that on the date of 6-15 2017, all monuments required by law were erected upon the subject claim(s), and all notices required by law were posted on the subject claim(s) or copies thereof were in place, and at said date, each corner monument bore or contained

RECEIVED
 BLM ASSET OFFICE
 PHOENIX, ARIZONA
 2017 SEP 27 10:30:01

markings sufficient to appropriately designate the corner of the claim to which it pertains and the name of the claim(s).

I hereby certify under penalty of perjury under the laws of the State of ARIZONA that the foregoing statements are true and correct:

Paul Klabača Date: 8-27-2017
(Signature of person responsible for above statement)

Title 18 U.S.C. 1001 and 43 U.S.C. 1212 make it a crime for any person knowingly and willfully to make to any department or agency of the United States any false, fictitious or fraudulent statements or representations as to any matter within its jurisdiction.

Notary Block

SUBSCRIBED AND SWORN TO before me, this 29 day of August 2017

By: Paul Klabača
(Signature of Affiant)

Title: _____

My Commission Expires: 01/30/2019



INSTRUCTIONS

1. This is an optional form that may be used to satisfy the requirements for the Bureau of Land Management (BLM) under the provisions of 43 U.S.C. §1744 and 30 U.S.C. §28-28d and the regulations thereunder (43 CFR part 3835). Since local and State laws may vary, you should contact your local and State agencies where the claims are located to ensure all applicable laws and requirements are satisfied.
2. The claimant(s) must fill in the date in paragraph 1 for the applicable assessment year and the county and state where the claims are located.
3. All claim names, BLM serial numbers, legal descriptions, and original county recording information must be listed for the claims pertaining to this assessment notice.
4. The claimant(s) must complete paragraph 2 listing all labor or improvements which was performed on or did benefit the subject mining claims. The value and date of the labor or improvements must also be listed. The total amount of labor or improvements can be listed, but the total expenditure must equal at least \$100 for each claim.
5. The names and current mailing addresses of the person(s) performing the labor shall be listed in paragraph 3.
6. The name and current mailing address of each owner (claimant) of the claims shall be listed in paragraph 4. The mailing address shall be the owner's address and not the address of an agent or anyone representing the claimant. Be sure to note if there has been a change of address.
7. Paragraph 5 shall be completed to show the date it was verified that all monuments required by law were properly erected, all notices were posted, and that corners were appropriately designated for all claims listed.
8. An exact legible reproduction or duplicate (other than microfilm or other electronic media) of this affidavit or another type of affidavit of assessment work that you file or will file in the county where each claim is located, must be filed with the BLM on or before December 30 of the calendar year in which the assessment year ends. For mill or tunnel sites, a separate notice of intent to hold must be filed with the BLM on or before December 30. Requirements for filing a notice of intent to hold can be found at 43 CFR 3835.33.
9. A processing fee of \$10 for each claim listed must be remitted to the BLM along with this or any other affidavit of assessment work.

STATE OF ILLINOIS
NOTARY PUBLIC
Samantha L Parish
01/30/2019

CLAYBACK DEVELOPMENT, LLC

1 LIMESTONE CT • LEMONT, IL 60435

RECEIVED
AZ STATE
2017 SEP -1 P 3:07
PHOENIX, ARIZONA



7017 1070 0000 8224 2539



1000



85004

U.S. POSTAGE
PAID
LEMONT, IL
60439
AUG 29, 17
AMOUNT

\$6.80

R2305K138989-09

BLM
ONE NORTH CENTRAL AVE.
SUITE #800
PHOENIX, AZ 85004-4427

RETURN RECEIPT
REQUESTED

85004-442700
ATTN: SUITE 800

CLAIMS DRAWN

CLAYBACK DEVELOPMENT, LLC

1 LIMESTONE CT • LEMONT, IL 60439

CERTIFIED MAIL



7017 1070 0000 8224 2539



1000

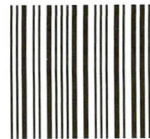

85004

U.S. POSTAGE
PAID
LEMONT, IL
60439
AUG 29, 17
AMOUNT

\$6.80

R2305K138989-09

BLM

ONE NORTH CENTRAL AVE.

SUITE #800

PHOENIX, AZ. 85004-4427

RECEIVED

BLM AZ STATE

2017 SEP -1 P 3:07

PHOENIX, ARIZONA

RECEIVED
POSTED

RETURN RECEIPT
REQUESTED

85004-442700

ATTN: SUZI CRUZE



CLAMS RENEWAL

United States Department of the Interior
Bureau of Land Management
 DIV OF LANDS, MINRLS & ENERGY
 ONE N CENTRAL AVE
 PHOENIX, AZ 85004 -4427
 Phone: 602-417-9200

Receipt

No: 3971331

| | |
|--|--|
| Transaction #: 4081265 | |
| Date of Transaction: 09/05/2017 | |
| CUSTOMER: | |
| PAUL KLABACHA 1 LIMESTONE CT LEMONT,IL 60439-2102 US | |

| LINE # | QTY | DESCRIPTION | REMARKS | UNIT PRICE | TOTAL |
|---------------|------|---|-------------------|------------|----------------|
| 1 | 1.00 | LOCATABLE MINERALS / MINING CLAIMS- NOT NEW-UNADJUD,ONE AUTH NO. ONLY / MINING CLAIM MONEY RECEIVED CASES: AMC410881/\$80.00 | POL 2017/8 WAV | - n/a - | 80.00 |
| TOTAL: | | | | | \$80.00 |

| PAYMENT INFORMATION | | | | | |
|---------------------|-----------|---|-------------|------------|--|
| 1 | AMOUNT: | 80.00 | POSTMARKED: | 08/29/2017 | |
| | TYPE: | CHECK | RECEIVED: | 09/01/2017 | |
| | CHECK NO: | 3925 | | | |
| | NAME: | CLAYBACK DEVELOPMENT 1 LIMESTONE CT LEMONT IL 60439-2102 US | | | |

| |
|---------|
| REMARKS |
| |

This receipt was generated by the automated BLM Collections and Billing System and is a paper representation of a portion of the official electronic record contained therein.

UNITED STATES
DEPARTMENT OF THE INTERIOR
BUREAU OF LAND MANAGEMENT

1523

MAINTENANCE FEE WAIVER CERTIFICATION

FORM APPROVED
OMB NO. 1004-0114
Expires: October 31, 2016

SEE INSTRUCTIONS ON PAGE 2

08 410881 411023

- This small miner waiver is filed for the assessment year beginning on September 1, 2016 and ending on September 1, 2017.
- The undersigned and all related parties owned ten or fewer mining claims, mill, or tunnel sites located and maintained on Federal lands in the United States of America on September 1, 2011.
- The undersigned have performed the assessment work required by law for each mining claim listed prior to filing this waiver and understand that by filing this form, the undersigned must file an affidavit of assessment work with the Bureau of Land Management (BLM) by the December 30th following the filing of this waiver.
- The undersigned understand that if the assessment work obligation has not yet come due under 30 U.S.C. 28 (for those claims in their first assessment year only), a notice of intent to hold reciting this condition must be recorded by the December 30th following the filing of this waiver.
- The undersigned understand that mill and tunnel sites may also be listed on this waiver and be waived from payment of the maintenance fee, and that a notice of intent to hold for these sites is required to be filed with the BLM by the December 30th following the filing of this waiver.
- The undersigned understand and acknowledge that pursuant to 43 U.S.C. 1212 and 18 U.S.C. 1001, the filing or recording of a false, fictitious, or fraudulent document with the BLM may result in a fine of up to \$250,000, a prison term not to exceed five years, or both.
- The mining claims, mill or tunnel sites for which this waiver from payment of the maintenance fees is requested are:

| CLAIM OR SITE NAME | BLM RECORDATION SERIAL NUMBER |
|--------------------|-------------------------------|
| 1. SILVERSTONE | 410881 ✓ |
| 2. SILVERSTONE 1 | 411023 |
| 3. SILVERSTONE 2 | 411024 |
| 4. SILVERSTONE 3 | 411025 |
| 5. SILVERSTONE 4 | 411026 |
| 6. SILVERSTONE 5 | 411027 |
| 7. SILVERSTONE 6 | 411028 |
| 8. SILVERSTONE 7 | 411029 |
| 9. | |
| 10. | |

The owner(s) (claimants) of the above mining claims and sites are:

PAUL KLABACHA

(Owner's Name - Please Print)

1 LIMESTONE COURT

(Owner's Mailing Address)

OCKINC@ATT.NET

(Owner's Name - Please Print)

312 316-7224

(Owner's Mailing Address)

(Owner's Name - Please Print)

(Owner's Mailing Address)

(Owner's Name - Please Print)

(Owner's Mailing Address)

Paul Klabacha

(Owner's Signature)

LEMONT

(City)

IL

(State)

60439

(Zip Code)

(Owner's Signature)

(City)

(State)

(Zip Code)

(Owner's Signature)

(City)

(State)

(Zip Code)

(Owner's Signature)

(City)

(State)

(Zip Code)

INTEREST
487
SEP 09 2016
BY: [Signature]

RECEIVED
BLM AZ STATE OFFICE
2016 AUG 29 P 3 02
PHOENIX, ARIZONA

NW 2
N

1000000000

5000000000000

1000000000000000

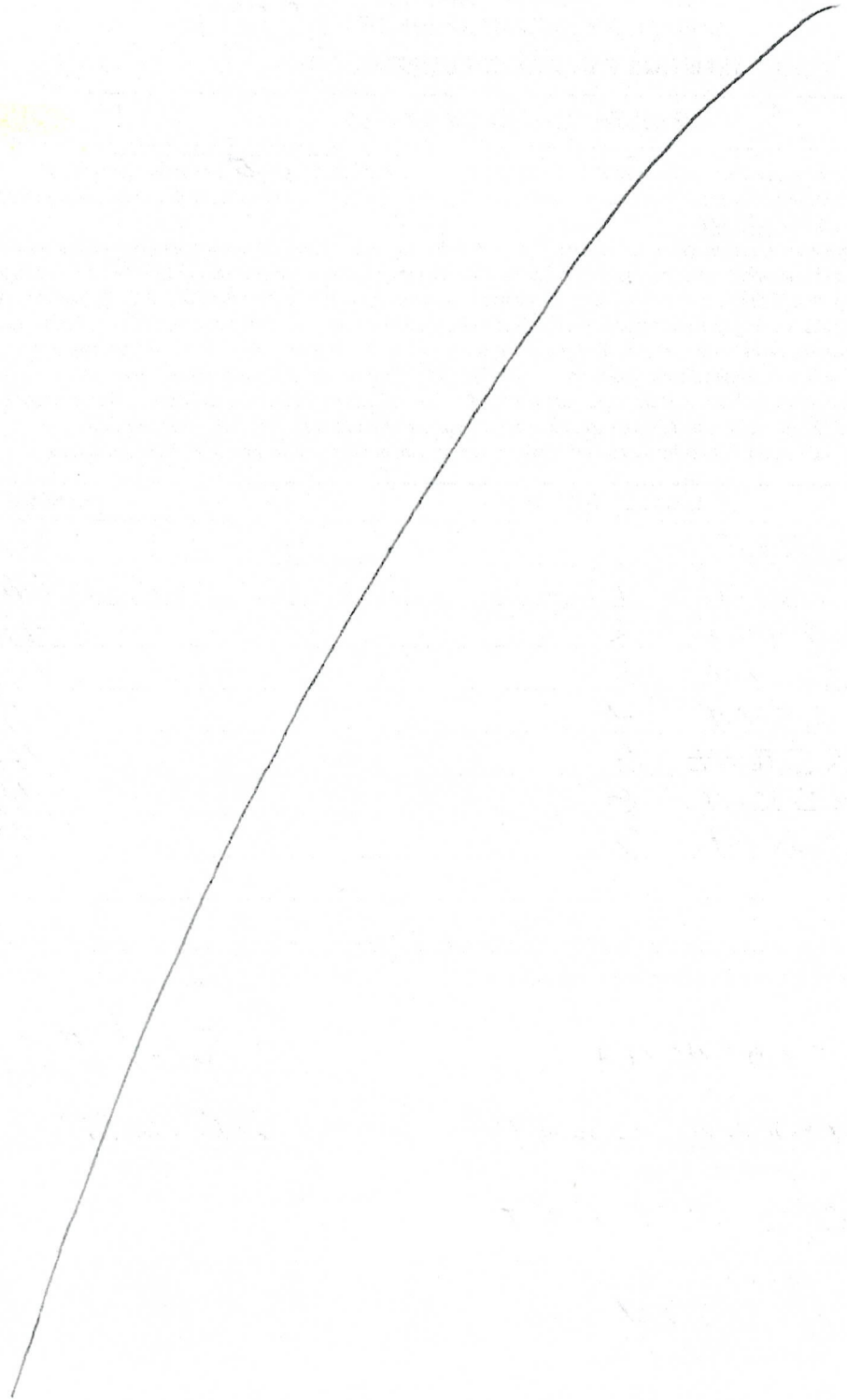

UNITED STATES
DEPARTMENT OF THE INTERIOR
BUREAU OF LAND MANAGEMENT

AFFIDAVIT OF ANNUAL ASSESSMENT WORK

410881 411023

WHEN RECORDED, MAIL DOCUMENT TO:

NAME: PAUL KLABACHA

ADDRESS: 1 LIMESTONE COURT

CITY, STATE, ZIP: LEMONT, IL 60439

FOR COUNTY RECORDER'S USE

No. of Claims 8
x \$10/claim
Total due BLM \$ 80.00

TO ALL WHOM IT MAY CONCERN:

1. The undersigned certifies that at least \$100 per claim was expended for development, labor and improvements, or equivalent value added, as the annual assessment work for the assessment year ending September 1, 2016 for the following contiguous unpatented mining claim(s), located in the County of YAVAPAI, in the State of ARIZONA.

| BLM Serial No. | Name of Claim | Tp | Rg | Sec | Mer | County Recordation Book and Page No. | Date |
|----------------|---------------|-----|----|-----|-----|--------------------------------------|------|
| 410881 | SILVERSTONE | 11N | 1W | 2 | | B 4882 P 905 | 2011 |
| 411023 | SILVERSTONE 1 | 11N | 1W | 2 | | B 4882 P 906 | 2011 |
| 411024 | SILVERSTONE 2 | 11N | 1W | 2 | | B 4882 P 907 | 2011 |
| 411025 | SILVERSTONE 3 | 11N | 1W | 2 | | B 4882 P 908 | 2011 |
| 411026 | SILVERSTONE 4 | 11N | 1W | 2 | | B 4882 P 909 | 2011 |
| 411027 | SILVERSTONE 5 | 11N | 1W | 2 | | B 4882 P 910 | 2011 |
| 411028 | SILVERSTONE 6 | 11N | 1W | 2 | | B 4882 P 911 | 2011 |
| 411029 | SILVERSTONE 7 | 11N | 1W | 2 | | B 4882 P 912 | 2011 |
| | | | | | | PHOENIX, ARIZONA | |
| | | | | | | 2016 AUG 29 P 3-02 | |

RECEIVED
BLM AZ STATE OFFICE

RECEIPT # 3646909

2. Type of labor and improvements (specify what was done and give the total value for that labor and improvement to show at least \$100 for each claim). If a geological, geochemical, or geophysical survey was performed, as per 30 U.S.C. 28-1, reference the title of the report of survey, give cost and date of the survey and report, and indicate it was filed with the County Recorder:

| Description of Work Performed | Value of Work Performed | Date Work Was Performed |
|-------------------------------|-------------------------|-------------------------|
| ROAD IMPROVEMENTS | 1,000.00 | 6-15-2016 |
| GRADING | | |
| CONCRETING WASHOUTS | | |
| BRUSH CUTTING | | |
| PANNING AND DETECTING | | |

3. Name and mailing address of each person who performed the labor and improvements:

Name (please print)

Current Mailing Address (please print)

PAUL KLABACHA

1 LIMESTONE COURT
LEMONT, IL. 60439

4. Name and mailing address of each person who holds and claims the subject mining claim(s) for the valuable minerals contained therein. Be sure to indicate if there is a change of address:

Name (please print)

Current Mailing Address (please print)

PAUL KLABACHA

1 LIMESTONE COURT
LEMONT, IL. 60439
OCKINC@ATT.NET
312 316-7224

RECEIVED
BLM AZ STATE OFFICE
AUG 29 P 3:02
PHOENIX ARIZONA

5. The undersigned testifies that on the date of 6-15, 2016, all monuments required by law were erected upon the subject claim(s), and all notices required by law were posted on the subject claim(s) or copies thereof were in place, and at said date, each corner monument bore or contained

markings sufficient to appropriately designate the corner of the claim to which it pertains and the name of the claim(s).

I hereby certify under penalty of perjury under the laws of the State of ARIZONA that the foregoing statements are true and correct:

Paul Klebacher Date: 8-24-2016
(Signature of person responsible for above statement)

Title 18 U.S.C. 1001 and 43 U.S.C. 1212 make it a crime for any person knowingly and willfully to make to any department or agency of the United States any false, fictitious or fraudulent statements or representations as to any matter within its jurisdiction.

Notary Block

SUBSCRIBED AND SWORN TO before me, this 25th day of August 2016

By: [Signature]
(Signature of Affiant)

Title: Notary

My Commission Expires: 01/30/2019



INSTRUCTIONS

- 1. This is an optional form that may be used to satisfy the requirements for the Bureau of Land Management (BLM) under the provisions of 43 U.S.C. §1744 and 30 U.S.C. §28-28d and the regulations thereunder (43 CFR part 3835). Since local and State laws may vary, you should contact your local and State agencies where the claims are located to ensure all applicable laws and requirements are satisfied.
- 2. The claimant(s) must fill in the date in paragraph 1 for the applicable assessment year and the county and state where the claims are located.
- 3. All claim names, BLM serial numbers, legal descriptions, and original county recording information must be listed for the claims pertaining to this assessment notice.
- 4. The claimant(s) must complete paragraph 2 listing all labor or improvements which was performed on or did benefit the subject mining claims. The value and date of the labor or improvements must also be listed. The total amount of labor or improvements can be listed, but the total expenditure must equal at least \$100 for each claim.
- 5. The names and current mailing addresses of the person(s) performing the labor shall be listed in paragraph 3.
- 6. The name and current mailing address of each owner (claimant) of the claims shall be listed in paragraph 4. The mailing address shall be the owner's address and not the address of an agent or anyone representing the claimant. Be sure to note if there has been a change of address.
- 7. Paragraph 5 shall be completed to show the date it was verified that all monuments required by law were properly erected, all notices were posted, and that corners were appropriately designated for all claims listed.
- 8. An exact legible reproduction or duplicate (other than microfilm or other electronic media) of this affidavit or another type of affidavit of assessment work that you file or will file in the county where each claim is located, must be filed with the BLM on or before December 30 of the calendar year in which the assessment year ends. For mill or tunnel sites, a separate notice of intent to hold must be filed with the BLM on or before December 30. Requirements for filing a notice of intent to hold can be found at 43 CFR 3835.33.
- 9. A processing fee of \$10 for each claim listed must be remitted to the BLM along with this or any other affidavit of assessment work.

PHOENIX, ARIZONA

RECEIVED
BLM AZ STATE OFFICE

CLAYBACK DEVELOPMENT, LLC

1 LIMESTONE CT • LEMONT, IL 60439



7016 0910 0000 5232 2417



UNITED STATES
POSTAL SERVICE

1000

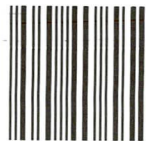

85004

U.S. POSTAGE
PAID
LEMONT, IL
60439
AUG 25, 16
AMOUNT

\$3.98

R2304H109239-22

BUREAU OF LAND MGMT.
1 NORTH CENTRAL AVE.
SUITE 800
PHOENIX, AZ. 85004-4427

RECEIVED
BLM AZ STATE OFFICE

2016 AUG 29 P 3:01

PHOENIX, ARIZONA

ATTN: SUZIE CRUZE

MINING CLAIMS

85004-442700



**United States Department of the Interior
Bureau of Land Management**

DIV OF LANDS, MINRLS & ENERGY
ONE N CENTRAL AVE
PHOENIX, AZ 85004 -4427
Phone: 602-417-9200

Receipt

No: 3646909

| | |
|--|--|
| Transaction #: 3750894 | |
| Date of Transaction: 08/30/2016 | |
| CUSTOMER: | |
| PAUL KLABACHA 1 LIMESTONE CT LEMONT,IL 60439-2102 US | |

| LINE # | QTY | DESCRIPTION | REMARKS | UNIT PRICE | TOTAL |
|---------------|------|--|--------------------------------|------------|----------------|
| 1 | 1.00 | LOCATABLE MINERALS / MINING CLAIMS-NOT NEW-UNADJUD,ONE AUTH NO. ONLY / MINING CLAIM MONEY RECEIVED CASES: AMC410881/\$80.00 | WAIVER 2017 - 8 / POL 2016 - 8 | - n/a - | 80.00 |
| TOTAL: | | | | | \$80.00 |

| PAYMENT INFORMATION | | | | | |
|---------------------|-----------|---|-------------|------------|--|
| 1 | AMOUNT: | 80.00 | POSTMARKED: | 08/25/2016 | |
| | TYPE: | CHECK | RECEIVED: | 08/29/2016 | |
| | CHECK NO: | 1791 | | | |
| | NAME: | KLABACHA, PAUL 1 LIMESTONE CT LEMONT IL 60439-2102 US | | | |

| |
|---------|
| REMARKS |
| |

This receipt was generated by the automated BLM Collections and Billing System and is a paper representation of a portion of the official electronic record contained therein.



UNITED STATES
DEPARTMENT OF THE INTERIOR
BUREAU OF LAND MANAGEMENT

469

410881
411023

FORM APPROVED
OMB NO. 1004-0114
Expires: October 31, 2016

MAINTENANCE FEE WAIVER CERTIFICATION

SEE INSTRUCTIONS ON PAGE 2

1. This small miner waiver is filed for the assessment year beginning on September 1, 2015 and ending on September 1, 2016.
2. The undersigned and all related parties owned ten or fewer mining claims, mill, or tunnel sites located and maintained on Federal lands in the United States of America on September 1, 2014. 2015 P.K.
3. The undersigned have performed the assessment work required by law for each mining claim listed prior to filing this waiver and understand that by filing this form, the undersigned must file an affidavit of assessment work with the Bureau of Land Management (BLM) by the December 30th following the filing of this waiver.
4. The undersigned understand that if the assessment work obligation has not yet come due under 30 U.S.C. 28 (for those claims in their first assessment year only), a notice of intent to hold reciting this condition must be recorded by the December 30th following the filing of this waiver.
5. The undersigned understand that mill and tunnel sites may also be listed on this waiver and be waived from payment of the maintenance fee, and that a notice of intent to hold for these sites is required to be filed with the BLM by the December 30th following the filing of this waiver.
6. The undersigned understand and acknowledge that pursuant to 43 U.S.C. 1212 and 18 U.S.C. 1001, the filing or recording of a false, fictitious, or fraudulent document with the BLM may result in a fine of up to \$250,000, a prison term not to exceed five years, or both.
7. The mining claims, mill or tunnel sites for which this waiver from payment of the maintenance fees is requested are:

| CLAIM OR SITE NAME | BLM RECORDATION SERIAL NUMBER |
|--------------------|-------------------------------|
| 1. SILVERSTONE | 410881 ✓ |
| 2. SILVERSTONE 1 | 411023 |
| 3. SILVERSTONE 2 | 411024 |
| 4. SILVERSTONE 3 | 411025 |
| 5. SILVERSTONE 4 | 411026 |
| 6. SILVERSTONE 5 | 411027 |
| 7. SILVERSTONE 6 | 411028 |
| 8. SILVERSTONE 7 | 411029 |
| 9. | |
| 10. | |

The owner(s) (claimants) of the above mining claims and sites are:

PAUL KLABACHA
(Owner's Name - Please Print)
1 LIMESTONE COURT
(Owner's Mailing Address)

Paul Klabacha
(Owner's Signature)
LEMONT IL 60439
(City) (State) (Zip Code)

(Owner's Name - Please Print)

(Owner's Mailing Address)

(Owner's Signature)

(City) (State) (Zip Code)

(Owner's Name - Please Print)

(Owner's Mailing Address)

(Owner's Signature)

(City) (State) (Zip Code)

(Owner's Name - Please Print)

(Owner's Mailing Address)

(Owner's Signature)

(City) (State) (Zip Code)

(Continued on page 2)

INTEREST
SEP 10 2015
BY: [Signature]

RECEIVED
BLM
PHOENIX, ARIZONA
AUG 26 3:20

NW
9/9/2015
[Signature]

(Owner's Name - Please Print)

(Owner's Signature)

(Owner's Mailing Address)

(City)

(State)

(Zip Code)

(Owner's Name - Please Print)

(Owner's Signature)

(Owner's Mailing Address)

(City)

(State)

(Zip Code)

(Owner's Name - Please Print)

(Owner's Signature)

(Owner's Mailing Address)

(City)

(State)

(Zip Code)

(Owner's Name - Please Print)

(Owner's Signature)

(Owner's Mailing Address)

(City)

(State)

(Zip Code)

18 U.S.C. 1001 and 43 U.S.C. 1212 make it a crime for any person knowingly and willfully to make to any department or agency of the United States any false, fictitious or fraudulent statements or representations as to any matter within its jurisdiction.

INSTRUCTIONS

1. This certification is made under the provisions of 43 U.S.C. § 1744 and 30 U.S.C. §28-28k and the regulations thereunder (43 CFR Part 3830).
2. The claimant(s) must fill in the dates in paragraph 1 for the beginning and ending of the assessment year for which this waiver is sought.
3. The claimant(s) must fill in the date in paragraph 2 for the beginning of the assessment year for which this waiver is sought.
4. All claim and site names and BLM serial numbers must be listed for the mining claims, mill sites, and tunnel sites for which the waiver is sought.
5. All owners of the mining claims, mill sites, and tunnel sites and their addresses must be given.
6. This waiver form must be signed by all the claimants or their designated agent, in original form. If an agent is designated, a notarized designation of agent, signed by all of the claimants with proper address given, must be submitted with this waiver.
7. This form must be filed no later than September 1st for the upcoming assessment year in the BLM State Office where the mining claims or sites are recorded, or the waiver cannot be granted by the BLM. (Example: To obtain a waiver for the assessment year 2012, which begins on September 1, 2011, you must qualify for and file for a waiver no later than September 1, 2011, in the proper BLM State Office.)
8. For all mining claims which require assessment work, you must record an affidavit of labor on or before the December 30th immediately following the filing of this waiver. For all other mining claims or sites waived, you must record a notice of intent to hold on or before the December 30th immediately following the filing of this waiver.
9. Mill and tunnel sites may also be listed on this waiver and be waived from payment of the maintenance fee. A notice of intent to hold for these sites is required to be filed by the December 30th following the filing of this waiver.

RECEIVED
BLM AZ STATE OFFICE
2015 AUG 26 P 3:20
PHOENIX, ARIZONA

FOR OFFICIAL USE ONLY

AFFIDAVIT OF ANNUAL ASSESSMENT WORK

WHEN RECORDED, MAIL DOCUMENT TO:

NAME: PAUL KLABACHA

ADDRESS: 1 LIMESTONE COURT

CITY, STATE, ZIP: LEMONT, IL. 60439

FOR COUNTY RECORDER'S USE

No. of Claims 8
x \$10/claim
Total due BLM \$ 80.00

TO ALL WHOM IT MAY CONCERN:

1. The undersigned certifies that at least \$100 per claim was expended for development, labor and improvements, or equivalent value added, as the annual assessment work for the assessment year ending September 1, 2015 for the following contiguous unpatented mining claim(s), located in the County of YAVAPAI, in the State of ARIZONA.

| BLM Serial No. | Name of Claim | Tp | Rg | Sec | Mer | County Recordation Book and Page No. | Date |
|----------------|---------------|------------------------|----|-----|-----|--------------------------------------|------|
| | | Example: 13N 5E 14 MDM | | | | | |
| 410881 | SILVERSTONE | 11N | 1W | 2 | | B 4882 P 905 | 2011 |
| 411023 | SILVERSTONE 1 | 11N | 1W | 2 | | B 4882 P 906 | 2011 |
| 411024 | SILVERSTONE 2 | 11N | 1W | 2 | | B 4882 P 907 | 2011 |
| 411025 | SILVERSTONE 3 | 11N | 1W | 2 | | B 4882 P 908 | 2011 |
| 411026 | SILVERSTONE 4 | 11N | 1W | 2 | | B 4882 P 909 | 2011 |
| 411027 | SILVERSTONE 5 | 11N | 1W | 2 | | B 4882 P 910 | 2011 |
| 411028 | SILVERSTONE 6 | 11N | 1W | 2 | | B 4882 P 911 | 2011 |
| 411029 | SILVERSTONE 7 | 11N | 1W | 2 | | B 4882 P 912 | 2011 |
| | | | | | | | |
| | | | | | | | |

PHOENIX, ARIZONA
 AUG 26 PM 3:20
 RECEIVED

ENTERED
 AUG 31 2015
 BY: je

(Continued on page 2)

SCRIPT # 3378740

2. Type of labor and improvements (specify what was done and give the total value for that labor and improvement to show at least \$100 for each claim). If a geological, geochemical, or geophysical survey was performed, as per 30 U.S.C. 28-1, reference the title of the report of survey, give cost and date of the survey and report, and indicate it was filed with the County Recorder:

| Description of Work Performed | Value of Work Performed | Date Work Was Performed |
|-------------------------------|-------------------------|-------------------------|
| ROAD WORK IMPROVEMENTS | 1,000.00 | 5-25-15 |
| | | |
| | | |
| | | |
| | | |

3. Name and mailing address of each person who performed the labor and improvements:

Name (please print)

Current Mailing Address (please print)

PAUL KLABACHA

1 LIMESTONE COURT
LEMONT, IL. 60439

4. Name and mailing address of each person who holds and claims the subject mining claim(s) for the valuable minerals contained therein. Be sure to indicate if there is a change of address:

Name (please print)

Current Mailing Address (please print)

PAUL KLABACHA

1 LIMESTONE COURT
LEMONT, IL 60439

PHOENIX, ARIZONA
 2015 AUG 26 P 3:20
 RECEIVED OFFICE

5. The undersigned testifies that on the date of 5-25, 2015, all monuments required by law were erected upon the subject claim(s), and all notices required by law were posted on the subject claim(s) or copies thereof were in place, and at said date, each corner monument bore or contained

markings sufficient to appropriately designate the corner of the claim to which it pertains and the name of the claim(s).

I hereby certify under penalty of perjury under the laws of the State of ARIZONA that the foregoing statements are true and correct:

Paul Klubochna Date: 8-18-2015
(Signature of person responsible for above statement)

Title 18 U.S.C. 1001 and 43 U.S.C. 1212 make it a crime for any person knowingly and willfully to make to any department or agency of the United States any false, fictitious or fraudulent statements or representations as to any matter within its jurisdiction.

Notary Block

SUBSCRIBED AND SWORN TO before me, this 21 day of August 20 15

By: [Signature]
(Signature of Affiant)

Title: _____

My Commission Expires: June 30, 2017

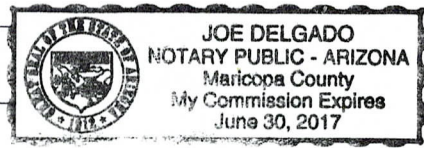

INSTRUCTIONS

1. This is an optional form that may be used to satisfy the requirements for the Bureau of Land Management (BLM) under the provisions of 43 U.S.C. §1744 and 30 U.S.C. §28-28d and the regulations thereunder (43 CFR part 3835). Since local and State laws may vary, you should contact your local and State agencies where the claims are located to ensure all applicable laws and requirements are satisfied.
2. The claimant(s) must fill in the date in paragraph 1 for the applicable assessment year and the county and state where the claims are located.
3. All claim names, BLM serial numbers, legal descriptions, and original county recording information must be listed for the claims pertaining to this assessment notice.
4. The claimant(s) must complete paragraph 2 listing all labor or improvements which was performed on or did benefit the subject mining claims. The value and date of the labor or improvements must also be listed. The total amount of labor or improvements can be listed, but the total expenditure must equal at least \$100 for each claim.
5. The names and current mailing addresses of the person(s) performing the labor shall be listed in paragraph 3.
6. The name and current mailing address of each owner (claimant) of the claims shall be listed in paragraph 4. The mailing address shall be the owner's address and not the address of an agent or anyone representing the claimant. Be sure to note if there has been a change of address.
7. Paragraph 5 shall be completed to show the date it was verified that all monuments required by law were properly erected, all notices were posted, and that corners were appropriately designated for all claims listed.
8. An exact legible reproduction or duplicate (other than microfilm or other electronic media) of this affidavit or another type of affidavit of assessment work that you file or will file in the county where each claim is located, must be filed with the BLM on or before December 30 of the calendar year in which the assessment year ends. For mill or tunnel sites, a separate notice of intent to hold must be filed with the BLM on or before December 30. Requirements for filing a notice of intent to hold can be found at 43 CFR 3835.33.
9. A processing fee of \$10 for each claim listed must be remitted to the BLM along with this or any other affidavit of assessment work.

PHOENIX ARIZONA JUN 29 P 3:20 RECEIVED

NOTICES

THE PRIVACY ACT and 43 CFR 2.48(d) require that you be furnished with the following information in connection with the information requested by this form.

AUTHORITY: 30 U.S.C. §28-28d and 43 CFR part 3835 permit collection of the information requested by this form.

PRINCIPAL PURPOSE: The BLM will use the information you provide to document compliance with 43 U.S.C. 1744 and that assessment work has been completed in accordance with 30 U.S.C. § 28-28d and 43 CFR part 3835 in lieu of paying the maintenance fee for the mining claims listed on this form.

ROUTINE USES: The BLM will only disclose this information in accordance with the provisions at 43 CFR 2.56(b) and (c).

EFFECT OF NOT PROVIDING INFORMATION: Disclosure of the requested information is required by 30 U.S.C. § 28-28d and 43 CFR part 3835 for claimants qualified to perform assessment work in lieu of paying the maintenance fee. Failure to submit all the requested information or to complete this form will delay the BLM's processing of the form and may preclude the BLM's acceptance of the assessment work information, which may result in forfeiture of the mining claim(s) by the claimant.

THE PAPERWORK REDUCTION ACT requires us to inform you that:

Use of this form is optional. You must perform assessment if a waiver to pay the maintenance fee has been requested. This form is provided to help you attest that annual assessment work has been completed in lieu of paying the maintenance fee for your claim(s). Submission of the requested information is necessary to obtain or retain a benefit.

You do not have to respond to this or any other Federal agency-sponsored information collection unless it displays a valid OMB control number.

BURDEN HOURS STATEMENT: The estimated public reporting burden for this form is 30 minutes per response, including the time for reviewing instructions, gathering and maintaining data, and completing and reviewing the form. You may submit comments regarding the burden estimate or any other aspect of this form to: U.S. Department of the Interior, Bureau of Land Management (1004-0114), Bureau Information Collection Clearance Officer (WO-630), 1849 C Street, N.W., Room 2134LM, Washington, D.C. 20240.

RECEIVED
BLM PHOENIX OFFICE
2015 AUG 26 P 3:20
PHOENIX, ARIZONA

CLAYBACK
DEVELOPMENT, LLC

~~P.O. Box 21 • Lemont, IL 60439~~

1 LIMESTONE CT.

2015 AUG 26 P 3:05

PHOENIX, ARIZONA

BLM

ONE NORTH CENTRAL AVE.

PHOENIX, ARIZONA

85004

PHOENIX AZ 852

29 AUG 2015 816 1



85004442700



CLAYBACK
DEVELOPMENT, LLC

RECEIVED
P.O. Box 21 • Lemont, IL 60439

1 LIMESTONE CT.

2015 AUG 26 P 3:05

PHOENIX, ARIZONA

BLM

ONE NORTH CENTRAL AVE.

PHOENIX, ARIZONA

85004

PHOENIX AZ 852

24 AUG 2015 PM 6 L



85004442700

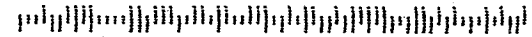

United States Department of the Interior
Bureau of Land Management
LANDS/RECREATION & PLANNING
ONE N CENTRAL AVE
PHOENIX, AZ 85004 -2203
Phone: 602-417-9200

Receipt

No: 3378740

| | |
|--|--|
| Transaction #: 3476992 | |
| Date of Transaction: 08/27/2015 | |
| CUSTOMER: | |
| PAUL KLABACHA 1 LIMESTONE CT LEMONT,IL 60439-2102 US | |

| LINE # | QTY | DESCRIPTION | REMARKS | UNIT PRICE | TOTAL |
|---------------|------|--|--------------------------------------|------------|----------------|
| 1 | 1.00 | LOCATABLE MINERALS / MINING CLAIMS-NOT NEW-UNADJUD,ONE AUTH NO. ONLY / MINING CLAIM MONEY RECEIVED CASES: AMC410881/\$80.00 | WAIVER - 8 2016 / POL - 8 2015 | - n/a - | 80.00 |
| TOTAL: | | | | | \$80.00 |

| PAYMENT INFORMATION | | | | |
|---|---------------|---|-------------|------------|
| NOTE: Items will appear on credit card statement as "Bureau of Land Mgmt CO". | | | | |
| 1 | AMOUNT: | 80.00 | POSTMARKED: | N/A |
| | TYPE: | CREDIT CARD | RECEIVED: | 08/26/2015 |
| | NAME: | KLABACHA, PAUL 1 LIMESTONE CT LEMONT IL 60439-2102 US | | |
| | CARD NO: | XXXXXXXXXXXX1003 | AUTH CODE: | 127189 |
| | NAME ON CARD: | PAUL KLABACHA | | |
| | EXPIRES: | 05/2020 | | |
| | SIGNATURE: | | | |

| REMARKS |
|---------|
| |

This receipt was generated by the automated BLM Collections and Billing System and is a paper representation of a portion of the official electronic record contained therein.

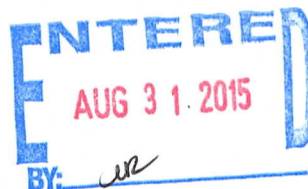

8/27/2015

UNITED STATES
DEPARTMENT OF THE INTERIOR
BUREAU OF LAND MANAGEMENT

1332

AMC 410881
411023

MAINTENANCE FEE WAIVER CERTIFICATION

AAA

FORM APPROVED
OMB NO. 1004-0114
Expires: October 31, 2016

SEE INSTRUCTIONS ON PAGE 2

1. This small miner waiver is filed for the assessment year beginning on September 1, 2014 and ending on September 1, 2015.
2. The undersigned and all related parties owned ten or fewer mining claims, mill, or tunnel sites located and maintained on Federal lands in the United States of America on September 1, 2011.
3. The undersigned have performed the assessment work required by law for each mining claim listed prior to filing this waiver and understand that by filing this form, the undersigned must file an affidavit of assessment work with the Bureau of Land Management (BLM) by the December 30th following the filing of this waiver.
4. The undersigned understand that if the assessment work obligation has not yet come due under 30 U.S.C. 28 (for those claims in their first assessment year only), a notice of intent to hold reciting this condition must be recorded by the December 30th following the filing of this waiver.
5. The undersigned understand that mill and tunnel sites may also be listed on this waiver and be waived from payment of the maintenance fee, and that a notice of intent to hold for these sites is required to be filed with the BLM by the December 30th following the filing of this waiver.
6. The undersigned understand and acknowledge that pursuant to 43 U.S.C. 1212 and 18 U.S.C. 1001, the filing or recording of a false, fictitious, or fraudulent document with the BLM may result in a fine of up to \$250,000, a prison term not to exceed five years, or both.
7. The mining claims, mill or tunnel sites for which this waiver from payment of the maintenance fees is requested are:

| CLAIM OR SITE NAME | BLM RECORDATION SERIAL NUMBER |
|--------------------|-------------------------------|
| 1. SILVERSTONE | ✓ 410881 |
| 2. SILVERSTONE 1 | 411023 |
| 3. SILVERSTONE 2 | 411024 |
| 4. SILVERSTONE 3 | 411025 |
| 5. SILVERSTONE 4 | 411026 |
| 6. SILVERSTONE 5 | 411027 |
| 7. SILVERSTONE 6 | 411028 |
| 8. SILVERSTONE 7 | 411029 |
| 9. | |
| 10. | |

The owner(s) (claimants) of the above mining claims and sites are:

PAUL KLABACHA

(Owner's Name - Please Print)

1 LIMESTONE COURT

(Owner's Mailing Address)

Paul Klabacha

(Owner's Signature)

LEMONT

(City)

IL

(State)

60439

(Zip Code)

(Owner's Name - Please Print)

(Owner's Mailing Address)

(Owner's Signature)

(City)

(State)

(Zip Code)

(Owner's Name - Please Print)

(Owner's Mailing Address)

(Owner's Signature)

(City)

(State)

(Zip Code)

(Owner's Name - Please Print)

(Owner's Mailing Address)

(Owner's Signature)

(City)

(State)

(Zip Code)

(Continued on page 2)

ENTERED
SEP 10 2014

BY: RM

RECEIVED
BLM AZ STATE OFFICE
2014 AUG 18 P 2:44
PHOENIX, ARIZONA

NWV
9/22/2014
pmv

(Owner's Name - Please Print)

(Owner's Signature)

(Owner's Mailing Address)

(City) (State) (Zip Code)

(Owner's Name - Please Print)

(Owner's Signature)

(Owner's Mailing Address)

(City) (State) (Zip Code)

(Owner's Name - Please Print)

(Owner's Signature)

(Owner's Mailing Address)

(City) (State) (Zip Code)

(Owner's Name - Please Print)

(Owner's Signature)

(Owner's Mailing Address)

(City) (State) (Zip Code)

18 U.S.C. 1001 and 43 U.S.C. 1212 make it a crime for any person knowingly and willfully to make to any department or agency of the United States any false, fictitious or fraudulent statements or representations as to any matter within its jurisdiction.

INSTRUCTIONS

1. This certification is made under the provisions of 43 U.S.C. § 1744 and 30 U.S.C. §28-28k and the regulations thereunder (43 CFR Part 3830).
2. The claimant(s) must fill in the dates in paragraph 1 for the beginning and ending of the assessment year for which this waiver is sought.
3. The claimant(s) must fill in the date in paragraph 2 for the beginning of the assessment year for which this waiver is sought.
4. All claim and site names and BLM serial numbers must be listed for the mining claims, mill sites, and tunnel sites for which the waiver is sought.
5. All owners of the mining claims, mill sites, and tunnel sites and their addresses must be given.
6. This waiver form must be signed by all the claimants or their designated agent, in original form. If an agent is designated, a notarized designation of agent, signed by all of the claimants with proper address given, must be submitted with this waiver.
7. This form must be filed no later than September 1st for the upcoming assessment year in the BLM State Office where the mining claims or sites are recorded, or the waiver cannot be granted by the BLM. (Example: To obtain a waiver for the assessment year 2012, which begins on September 1, 2011, you must qualify for and file for a waiver no later than September 1, 2011, in the proper BLM State Office.)
8. For all mining claims which require assessment work, you must record an affidavit of labor on or before the December 30th immediately following the filing of this waiver. For all other mining claims or sites waived, you must record a notice of intent to hold on or before the December 30th immediately following the filing of this waiver.
9. Mill and tunnel sites may also be listed on this waiver and be waived from payment of the maintenance fee. A notice of intent to hold for these sites is required to be filed by the December 30th following the filing of this waiver.

PHOENIX ARIZONA
RECEIVED
BLM STATE OFFICE
OCT 18 2:45 PM

FOR OFFICIAL USE ONLY

UNITED STATES
DEPARTMENT OF THE INTERIOR
BUREAU OF LAND MANAGEMENT

FORM APPROVED
OMB NO.: 1004-0114
Expires: October 31, 2016
Ame 411023
410881

AFFIDAVIT OF ANNUAL ASSESSMENT WORK

WHEN RECORDED, MAIL DOCUMENT TO:

NAME: PAUL KLABACHA

ADDRESS: 1 LIMESTONE COURT

CITY, STATE, ZIP: LEMONT, IL,
60439

FOR COUNTY RECORDER'S USE

No. of Claims 8
x \$10/claim
Total due BLM \$ 80

TO ALL WHOM IT MAY CONCERN:

1. The undersigned certifies that at least \$100 per claim was expended for development, labor and improvements, or equivalent value added, as the annual assessment work for the assessment year ending September 1, 2014 for the following contiguous unpatented mining claim(s), located in the County of YAVAPAI, in the State of ARIZONA.

| BLM Serial No. | Name of Claim | Tp | Rg | Sec | Mer | County Recordation Book and Page No. | Date |
|----------------|---------------|-----|----|-----|-----|--------------------------------------|---------|
| 410881 | SILVERSTONE | 11N | 1W | 2 | | B4882-P905 | 5-15-11 |
| 411023 | SILVERSTONE 1 | 11N | 1W | 2 | | B4882-P906 | 5-15-11 |
| 411024 | SILVERSTONE 2 | 11N | 1W | 2 | | B4882-P907 | 5-15-11 |
| 411025 | SILVERSTONE 3 | 11N | 1W | 2 | | B4882-P908 | 5-15-11 |
| 411026 | SILVERSTONE 4 | 11N | 1W | 2 | | B4882-P909 | 5-15-11 |
| 411027 | SILVERSTONE 5 | 11N | 1W | 2 | | B4882-P910 | 5-15-11 |
| 411028 | SILVERSTONE 6 | 11N | 1W | 2 | | B4882-P911 | 5-15-11 |
| 411029 | SILVERSTONE 7 | 11N | 1W | 2 | | B4882-P912 | 5-15-11 |
| | | | | | | | |

RECEIVED
BLM AZ STATE OFFICE
2014 AUG 18 P 2:44
PHOENIX, ARIZONA

(Continued on page 2)

ENTERED
AUG 20 2014
BY: RMT

RECEIPT # 3105510

2. Type of labor and improvements (specify what was done and give the total value for that labor and improvement to show at least \$100 for each claim). If a geological, geochemical, or geophysical survey was performed, as per 30 U.S.C. 28-1, reference the title of the report of survey, give cost and date of the survey and report, and indicate it was filed with the County Recorder:

| Description of Work Performed | Value of Work Performed | Date Work Was Performed |
|-------------------------------|-------------------------|-------------------------|
| ROAD WORK MAINTENANCE | 1500.00 | MAY 15 2014 |
| PANNING + DETECTING | 1000.00 | JUNE - AUGUST 2014 |
| | | |
| | | |

3. Name and mailing address of each person who performed the labor and improvements:

Name (please print)

PAUL KLABACHA
KAREN KLABACHA
PETRA JOUANOVICH
ELIZABETH JOUANOVICH

Current Mailing Address (please print)

1 LIMESTONE COURT LEMONT, IL. 60439
1703 SHERWOOD PRERSCOTT, AZ. 86305
12210 S. REXFORD ALSIP, IL. 60803
1 LIMESTONE COURT LEMONT, IL. 60439

4. Name and mailing address of each person who holds and claims the subject mining claim(s) for the valuable minerals contained therein. Be sure to indicate if there is a change of address:

Name (please print)

PAUL KLABACHA
ELIZABETH JOUANOVICH

Current Mailing Address (please print)

1 LIMESTONE COURT LEMONT IL 60439
1 LIMESTONE COURT LEMONT IL 60439

RECEIVED
 BLM AZ STATE OFFICE
 2011 AUG 18 P 2:44
 PHOENIX, ARIZONA

5. The undersigned testifies that on the date of MAY 15TH, 2011, all monuments required by law were erected upon the subject claim(s), and all notices required by law were posted on the subject claim(s) or copies thereof were in place, and at said date, each corner monument bore or contained

markings sufficient to appropriately designate the corner of the claim to which it pertains and the name of the claim(s).

I hereby certify under penalty of perjury under the laws of the State of ARIZONA that the foregoing statements are true and correct:

Paul Klabacha Date: 8-15-2014
(Signature of person responsible for above statement)

Title 18 U.S.C. 1001 and 43 U.S.C. 1212 make it a crime for any person knowingly and willfully to make to any department or agency of the United States any false, fictitious or fraudulent statements or representations as to any matter within its jurisdiction.

Notary Block

SUBSCRIBED AND SWORN TO before me, this 15th day of August 20 14

By: Mary E. Lesnieski
(Signature of Affiant)

Title: Administrative Assistant



My Commission Expires: 1-30-16

INSTRUCTIONS

1. This is an optional form that may be used to satisfy the requirements for the Bureau of Land Management (BLM) under the provisions of 43 U.S.C. §1744 and 30 U.S.C. §28-28d and the regulations thereunder (43 CFR part 3835). Since local and State laws may vary, you should contact your local and State agencies where the claims are located to ensure all applicable laws and requirements are satisfied.
2. The claimant(s) must fill in the date in paragraph 1 for the applicable assessment year and the county and state where the claims are located.
3. All claim names, BLM serial numbers, legal descriptions, and original county recording information must be listed for the claims pertaining to this assessment notice.
4. The claimant(s) must complete paragraph 2 listing all labor or improvements which was performed on or did benefit the subject mining claims. The value and date of the labor or improvements must also be listed. The total amount of labor or improvements can be listed, but the total expenditure must equal at least \$100 for each claim.
5. The names and current mailing addresses of the person(s) performing the labor shall be listed in paragraph 3.
6. The name and current mailing address of each owner (claimant) of the claims shall be listed in paragraph 4. The mailing address shall be the owner's address and not the address of an agent or anyone representing the claimant. Be sure to note if there has been a change of address.
7. Paragraph 5 shall be completed to show the date it was verified that all monuments required by law were properly erected, all notices were posted, and that corners were appropriately designated for all claims listed.
8. An exact legible reproduction or duplicate (other than microfilm or other electronic media) of this affidavit or another type of affidavit of assessment work that you file or will file in the county where each claim is located, must be filed with the BLM on or before December 30 of the calendar year in which the assessment year ends. For mill or tunnel sites, a separate notice of intent to hold must be filed with the BLM on or before December 30. Requirements for filing a notice of intent to hold can be found at 43 CFR 3835.33.
9. A processing fee of \$10 for each claim listed must be remitted to the BLM along with this or any other affidavit of assessment work.

RECEIVED
BLM STATE OFFICE
AUG 18 P 2:44
PINAL
ARIZONA

CERTIFIED MAIL™

CLAYBACK
DEVELOPMENT, LLC

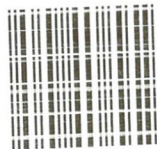

U.S. POSTAGE
PAID
LEMONT, IL
60439
AUG 15, 14
AMOUNT

\$6.70

00046490-03

P.O. Box 21 • Lemont, IL 60439

1 LIMESTONE CT.

RECEIVED

ARIZONA STATE OFFICE

13 2630 0001 1267 4818

2014 AUG 18 P 2:44

BUREAU OF LAND MANAGEMENT

PHOENIX, ARIZONA

ARIZONA STATE OFFICE

ONE NORTH CENTRAL AVE. SUITE 800

PHOENIX, ARIZONA

85004-4427

RETURN RECEIPT
REQUESTED

85004-4427



CERTIFIED MAIL™

CLAYBACK
DEVELOPMENT, LLC

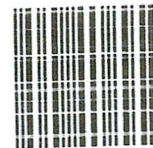
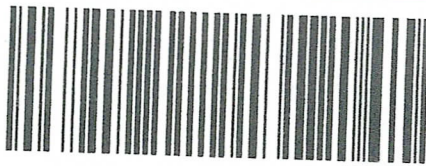

U.S. POSTAGE
PAID
LEMONT, IL
60439
AUG 15, 14
AMOUNT

\$6.70
00046490-03

~~P.O. Box 21 • Lemont, IL 60439~~

1 LIMESTONE CT.

RECEIVED
BU... STATE OFFICE
13 2630 0001 1267 4818

2014 AUG 18 P 2:44
BUREAU OF LAND MANAGEMENT

PHOENIX, ARIZONA

ARIZONA STATE OFFICE
ONE NORTH CENTRAL AVE. SUITE 800
PHOENIX, ARIZONA

85004-4427

RETURN RECEIPT
REQUESTED

8500433003

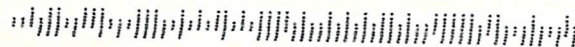

United States Department of the Interior
Bureau of Land Management
 LANDS/RECREATION & PLANNING
 ONE N CENTRAL AVE
 PHOENIX, AZ 85004 -2203
 Phone: 602-417-9200



Receipt

No: 3105510

| | |
|--|--|
| Transaction #: 3197161 | |
| Date of Transaction: 08/19/2014 | |
| CUSTOMER: | |
| PAUL KLABACHA 1 LIMESTONE CT LEMONT,IL 60439-2102 US | |

| LINE # | QTY | DESCRIPTION | REMARKS | UNIT PRICE | TOTAL |
|---------------|------|--|--|------------|----------------|
| 1 | 1.00 | LOCATABLE MINERALS / MINING CLAIMS-NOT NEW-UNADJUD,ONE AUTH NO. ONLY / MINING CLAIM MONEY RECEIVED CASES: AMC410881/\$80.00 | MAINT FEE WAIVER (8) 2015 / POL (8) 2014 | - n/a - | 80.00 |
| TOTAL: | | | | | \$80.00 |

| PAYMENT INFORMATION | | | | | |
|---------------------|-----------|---|-------------|------------|--|
| 1 | AMOUNT: | 80.00 | POSTMARKED: | 08/15/2014 | |
| | TYPE: | CHECK | RECEIVED: | 08/18/2014 | |
| | CHECK NO: | 3322 | | | |
| | NAME: | CLAYBACK DEVELOPMENT 1 LIMESTONE CT LEMONT IL 60439-2102 US | | | |

| REMARKS |
|---------|
| |

This receipt was generated by the automated BLM Collections and Billing System and is a paper representation of a portion of the official electronic record contained therein.

UNITED STATES
DEPARTMENT OF THE INTERIOR
BUREAU OF LAND MANAGEMENT

410881

ncH

FORM APPROVED
OMB NO. 1004-0114
Expires: August 31, 2013

MAINTENANCE FEE WAIVER CERTIFICATION

SEE INSTRUCTIONS ON PAGE 2

411023

1. This small miner waiver is filed for the assessment year beginning on September 1, 2013 and ending on September 1, 2014.
2. The undersigned and all related parties owned ten or fewer mining claims, mill, or tunnel sites located and maintained on Federal lands in the United States of America on September 1, 2011.
3. The undersigned have performed the assessment work required by law for each mining claim listed prior to filing this waiver and understand that by filing this form, an affidavit of assessment work must be recorded by the December 30th following the filing of this waiver.
4. The undersigned understand that if the assessment work obligation has not yet come due under 30 U.S.C. 28 (for those claims in their first assessment year only), a notice of intent to hold reciting this condition must be recorded by the December 30th following the filing of this waiver.
5. The undersigned understand that mill and tunnel sites may also be listed upon this waiver and be waived from payment of the maintenance fee, and that a notice of intent to hold for these sites is required to be recorded by the December 30th immediately following the filing of this waiver.
6. The undersigned understand and acknowledge that pursuant to 43 U.S.C. 1212 and 18 U.S.C. 1001, the filing or recording of a false, fictitious, or fraudulent document with the Bureau of Land Management may result in a fine of up to \$250,000, a prison term not to exceed five years, or both.
7. The mining claims, mill or tunnel sites for which this waiver from payment of the maintenance fees is requested are:

| CLAIM OR SITE NAME | BLM RECORDATION SERIAL NUMBER |
|--------------------|-------------------------------|
| 1. SILVERSTONE ✓ | 410881 |
| 2. SILVERSTONE 1 | 411023 |
| 3. SILVERSTONE 2 | 411024 |
| 4. SILVERSTONE 3 | 411025 |
| 5. SILVERSTONE 4 | 411026 |
| 6. SILVERSTONE 5 | 411027 |
| 7. SILVERSTONE 6 | 411028 |
| 8. SILVERSTONE 7 | 411029 |
| 9. | |
| 10. | |

The owner(s) (claimants) of the above mining claims and sites are:

PAUL KLABACHA
(Owner's Name - Please Print)

Paul Klabacha
(Owner's Signature)

1 LIMESTONE COURT
(Street or P.O. Box)

LEMONT IL 60439
(City) (State) (Zip Code)

(Owner's Name - Please Print)

(Owner's Signature)

(Street or P.O. Box)

(City) (State) (Zip Code)

(Owner's Name - Please Print)

(Owner's Signature)

(Street or P.O. Box)

(City) (State) (Zip Code)

ENTERED
SEP 17 2013
BY: *RE*

| | | | |
|-------------------------------|---------------------|---------|------------|
| (Owner's Name - Please Print) | (Owner's Signature) | | |
| (Street or P.O. Box) | (City) | (State) | (Zip Code) |
| | | | |
| (Owner's Name - Please Print) | (Owner's Signature) | | |
| (Street or P.O. Box) | (City) | (State) | (Zip Code) |
| | | | |
| (Owner's Name - Please Print) | (Owner's Signature) | | |
| (Street or P.O. Box) | (City) | (State) | (Zip Code) |
| | | | |
| (Owner's Name - Please Print) | (Owner's Signature) | | |
| (Street or P.O. Box) | (City) | (State) | (Zip Code) |

Title 18 U.S.C. Section 1001 and Title 43 U.S.C. Section 1212 makes it a crime for any person knowingly and willfully to make to any department or agency of the United States any false, fictitious or fraudulent statements or representations as to any matter within its jurisdiction.

INSTRUCTIONS

1. This certification is made under the provisions of §1744 of Title 43 and § 28-28k of Title 30 of the United States Code; and the regulations thereunder (43 CFR Part 3830).
2. The claimant(s) must fill in the dates in paragraph 1 for the beginning and ending of the assessment year for which this waiver is sought.
3. The claimant(s) must fill in the date in paragraph 2 for the beginning of the assessment year for which this waiver is sought.
4. All claim and site names and Bureau of Land Management (BLM) serial numbers must be listed for the mining claims, mill sites, and tunnel sites for which the waiver is sought.
5. All owners of the mining claims, mill sites, and tunnel sites and their addresses must be given.
6. This waiver form must be signed by all the claimants or their designated agent, in original form. If an agent is designated, a notarized designation of agent, signed by all of the claimants with proper address given, must be submitted with this waiver.
7. This form must be filed no later than September 1st for the upcoming assessment year in the BLM State Office where the mining claims or sites are recorded, or the waiver cannot be granted by the BLM. (Example: To obtain a waiver for the assessment year 2012, which begins on September 1, 2011, you must qualify for and file for a waiver no later than September 1, 2011, in the proper BLM State Office.)
8. For all mining claims which require assessment work, you must record an affidavit of labor on or before the December 30th immediately following the filing of this waiver. For all other mining claims or sites waived, you must record a notice of intent to hold on or before the December 30th immediately following the filing of this waiver.
9. Mill and tunnel sites may also be listed upon this waiver and be waived from payment of the maintenance fee. A notice of intent to hold for these sites is required to be filed by the December 30th following the filing of this waiver.

FOR OFFICIAL USE ONLY

When Recorded Return Document to:

PAUL KLABACKA
1 LIMESTONE COURT
LEMONT, IL.
60439

Check here is this is a change of address.

Telephone: 312 316-7224

E-mail address: OCKINC@ATT.NET

AFFIDAVIT OF PERFORMANCE OF ANNUAL WORK

1. State of Arizona, County of YAVAPAI ss:

2. I (Name) PAUL KLABACKA

3. Reside at (Address) 1 LIMESTONE COURT

City LEMONT County COOK

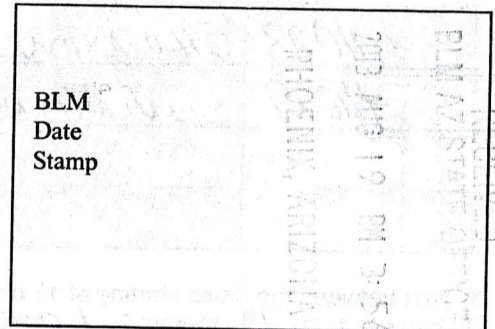

State IL Zip 60439 being duly sworn, depose and say that I am a citizen of the United States, more than eighteen years of age, and that all of the facts set forth in this affidavit, subject to the provisions and penalties of 18 U.S.C. 1001 pertaining to the filing of false, fictitious, or fraudulent statements with the United States, are true and correct according to the best of my knowledge, information and belief.

4. Owner's name and address (If not shown in Items 1-3 above), _____

5. That I am personally acquainted with the mining claim(s). The work and improvements were made by and at the expense of the owner(s) of said claim(s). Said contiguous group of claims, listed on this document, are situated in the

(optional) Mining District; YAVAPAI County, Arizona.

| Line No. | AMC NUMBER | CLAIM/SITE NAME | COUNTY RECORDER DATA (If available) | TWP | RNG | SEC |
|----------|------------|-----------------|-------------------------------------|-----|-----|-----|
| 1 | 410881 | SILVERSTONE | B 4882 P 905 | 11N | 1W | 2 |
| 2 | 411023 | SILVERSTONE 1 | B 4882 P 906 | 11N | 1W | 2 |
| 3 | 411024 | SILVERSTONE 2 | B 4882 P 907 | 11N | 1W | 2 |
| 4 | 411025 | SILVERSTONE 3 | B 4882 P 908 | 11N | 1W | 2 |
| 5 | 411026 | SILVERSTONE 4 | B 4882 P 909 | 11N | 1W | 2 |
| 6 | 411027 | SILVERSTONE 5 | B 4882 P 910 | 11N | 1W | 2 |

Form: MCF108

Revised Jan. 2006

Page 1 of 2

ENTERED
SEP 04 2013
BY: HT

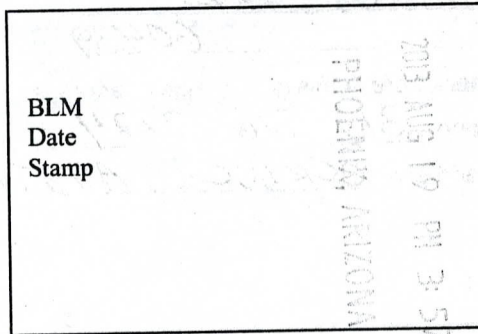

RECEIVED
BLM AZ STATE OFFICE

| | | | | | | |
|----|--------|---------------|------------|-----|----|---|
| 7 | 411028 | SILVERSTONE 6 | B4882 P911 | 11N | 1W | 2 |
| 8 | 411029 | SILVERSTONE 7 | B4882 P912 | 11N | 1W | 2 |
| 9 | | | | | | |
| 10 | | | | | | |

6. That between the dates starting at 12 o'clock noon on September 1, 20 12 and ending at 12 o'clock noon on September 1, 20 13 at least \$ 1,000 dollars worth of work and improvements were done and performed upon said claim(s) or upon one or more of a contiguous group of claims for the benefit of all, wholly or partly outside of a contiguous group of claims for the benefit of all, not including the location work.

7. That the following persons were employed to perform the work and improvements described herein: _____

PAUL KLABACHA KAREN KLABACHA KEN MANORFIELD

8. That the work and improvements performed were: ROAD WORK MAINTENANCE,

PANNING AND DETECTING

9. Dated: 8-15-13 Signature: Paul Klabacha

SUBSCRIBED AND SWORN TO before me, a Notary Public, this 15TH day of AUGUST 20 13

By: Patricia A Shaffer

Notary Public: Patricia A Shaffer

My Commission Expires 5-15-2016



No. of Claims: 8 x \$10 = 80
 Check No.: 3141 Init. PKH
 Receipt No.: 2859865
 For BLM Use Only

Bureau of Land Management
 Arizona State Office
www.az.blm.gov

CLAYBACK
DEVELOPMENT, LLC

~~PO. Box 21~~ • Lemont, IL 60439

1 LIMESTONE COURT

BLM
ONE N CENTRAL AVE
PHOENIX, AZ. 85004-2203



X, ARIZONA
7 PM 3/13
FEB 13 2013

MINING CLAIMS RENEWAL  ATTN: SUSIE CRUZE

**United States Department of the Interior
Bureau of Land Management
LANDS/RECREATION & PLANNING
ONE N CENTRAL AVE
PHOENIX, AZ 85004 -2203
Phone: 602-417-9200**

Receipt

No: 2859865

| | |
|--|--|
| Transaction #: 2945719 | |
| Date of Transaction: 08/20/2013 | |
| CUSTOMER: | |
| PAUL KLABACHA 1 LIMESTONE CT LEMONT,IL 60439-2102 US | |

| LINE # | QTY | DESCRIPTION | REMARKS | UNIT PRICE | TOTAL |
|---------------|------|--|-------------------|------------|----------------|
| 1 | 1.00 | LOCATABLE MINERALS / MINING CLAIMS- NOT NEW-UNADJUD,ONE AUTH NO. ONLY / MINING CLAIM MONEY RECEIVED CASES: AMC410881/\$80.00 | POL 2013/8 WAV | - n/a - | 80.00 |
| TOTAL: | | | | | \$80.00 |

| PAYMENT INFORMATION | | | | | |
|---------------------|-----------|---|-------------|------------|--|
| 1 | AMOUNT: | 80.00 | POSTMARKED: | 08/15/2013 | |
| | TYPE: | CHECK | RECEIVED: | 08/19/2013 | |
| | CHECK NO: | 3141 | | | |
| | NAME: | CLAYBACK DEVELOPMENT 1 LIMESTONE CT LEMONT IL 60439-2102 US | | | |

| | |
|----------------|--|
| REMARKS | |
| | |

This receipt was generated by the automated BLM Collections and Billing System and is a paper representation of a portion of the official electronic record contained therein.

UNITED STATES
DEPARTMENT OF THE INTERIOR
BUREAU OF LAND MANAGEMENT

MAINTENANCE FEE WAIVER CERTIFICATION

A.A.

FORM APPROVED
OMB NO. 1004-0114
Expires: August 31, 2013

336

410881
411023

SEE INSTRUCTIONS ON PAGE 2

- This small miner waiver is filed for the assessment year beginning on September 1, 2012 and ending on September 1, 2013.
- The undersigned and all related parties owned ten or fewer mining claims, mill, or tunnel sites located and maintained on Federal lands in the United States of America on September 1, 2011.
- The undersigned have performed the assessment work required by law for each mining claim listed prior to filing this waiver and understand that by filing this form, an affidavit of assessment work must be recorded by the December 30th following the filing of this waiver.
- The undersigned understand that if the assessment work obligation has not yet come due under 30 U.S.C. 28 (for those claims in their first assessment year only), a notice of intent to hold reciting this condition must be recorded by the December 30th following the filing of this waiver.
- The undersigned understand that mill and tunnel sites may also be listed upon this waiver and be waived from payment of the maintenance fee, and that a notice of intent to hold for these sites is required to be recorded by the December 30th immediately following the filing of this waiver.
- The undersigned understand and acknowledge that pursuant to 43 U.S.C. 1212 and 18 U.S.C. 1001, the filing or recording of a false, fictitious, or fraudulent document with the Bureau of Land Management may result in a fine of up to \$250,000, a prison term not to exceed five years, or both.
- The mining claims, mill or tunnel sites for which this waiver from payment of the maintenance fees is requested are:

| CLAIM OR SITE NAME | BLM RECORDATION SERIAL NUMBER |
|--------------------|-------------------------------|
| 1. SILVERSTONE ✓ | 410881 |
| 2. SILVERSTONE 1 | 411023 |
| 3. SILVERSTONE 2 | 411024 |
| 4. SILVERSTONE 3 | 411025 |
| 5. SILVERSTONE 4 | 411026 |
| 6. SILVERSTONE 5 | 411027 |
| 7. SILVERSTONE 6 | 411028 |
| 8. SILVERSTONE 7 | 411029 |
| 9. | |
| 10. | |

The owner(s) (claimants) of the above mining claims and sites are:

PAUL KLABACHA
(Owner's Name - Please Print)

Paul Klabacha
(Owner's Signature)

1 LIMESTONE COURT
(Street or P.O. Box)

LEMONT IL 60439
(City) (State) (Zip Code)

(Owner's Name - Please Print)

(Owner's Signature)

(Street or P.O. Box)

(City) (State) (Zip Code)

(Owner's Name - Please Print)

(Owner's Signature)

(Street or P.O. Box)

(City) (State) (Zip Code)

PHOENIX ARIZONA
RECEIVED
BLM AZ STATE OFFICE
2012 AUG 29 A 10:16

PHOENIX ARIZONA
RECEIVED
BLM AZ STATE OFFICE
2012 AUG 29 A 10:16

ENTERED IN COMPUTER

RE 9-13-12

NL
RE

| | | | |
|-------------------------------|---------------------|---------|------------|
| (Owner's Name - Please Print) | (Owner's Signature) | | |
| (Street or P.O. Box) | (City) | (State) | (Zip Code) |
| | | | |
| (Owner's Name - Please Print) | (Owner's Signature) | | |
| (Street or P.O. Box) | (City) | (State) | (Zip Code) |
| | | | |
| (Owner's Name - Please Print) | (Owner's Signature) | | |
| (Street or P.O. Box) | (City) | (State) | (Zip Code) |
| | | | |
| (Owner's Name - Please Print) | (Owner's Signature) | | |
| (Street or P.O. Box) | (City) | (State) | (Zip Code) |

Title 18 U.S.C. Section 1001 and Title 43 U.S.C. Section 1212 makes it a crime for any person knowingly and willfully to make to any department or agency of the United States any false, fictitious or fraudulent statements or representations as to any matter within its jurisdiction.

INSTRUCTIONS

1. This certification is made under the provisions of §1744 of Title 43 and § 28-28k of Title 30 of the United States Code; and the regulations thereunder (43 CFR Part 3830).
2. The claimant(s) must fill in the dates in paragraph 1 for the beginning and ending of the assessment year for which this waiver is sought.
3. The claimant(s) must fill in the date in paragraph 2 for the beginning of the assessment year for which this waiver is sought.
4. All claim and site names and Bureau of Land Management (BLM) serial numbers must be listed for the mining claims, mill sites, and tunnel sites for which the waiver is sought.
5. All owners of the mining claims, mill sites, and tunnel sites and their addresses must be given.
6. This waiver form must be signed by all the claimants or their designated agent, in original form. If an agent is designated, a notarized designation of agent, signed by all of the claimants with proper address given, must be submitted with this waiver.
7. This form must be filed no later than September 1st for the upcoming assessment year in the BLM State Office where the mining claims or sites are recorded, or the waiver cannot be granted by the BLM. (Example: To obtain a waiver for the assessment year 2012, which begins on September 1, 2011, you must qualify for and file for a waiver no later than September 1, 2011, in the proper BLM State Office.)
8. For all mining claims which require assessment work, you must record an affidavit of labor on or before the December 30th immediately following the filing of this waiver. For all other mining claims or sites waived, you must record a notice of intent to hold on or before the December 30th immediately following the filing of this waiver.
9. Mill and tunnel sites may also be listed upon this waiver and be waived from payment of the maintenance fee. A notice of intent to hold for these sites is required to be filed by the December 30th following the filing of this waiver.

BLM AZ STATE OFFICE
 PHOENIX ARIZONA
 2015 AUG 20 A 10:19
 RECEIVED

BLM AZ STATE OFFICE
 PHOENIX ARIZONA
 2012 AUG 20 A 10:15
 RECEIVED

FOR OFFICIAL USE ONLY

When Recorded Return Document to:

PAUL KLABACHA
1 LIMESTONE COURT
LEMONT, IL.
60439

Check here is this is a change of address.

Telephone: 312 316-7224

E-mail address: OCKINC@ATT.NET

AFFIDAVIT OF PERFORMANCE OF ANNUAL WORK

1. State of Arizona, County of YAVAPAI ss:

2. I (Name) PAUL KLABACHA

3. Reside at (Address) 1 LIMESTONE COURT

City LEMONT County COOK

RECEIVED
BLM
AZ STATE OFFICE
2012 AUG 20 A 10:16
PHOENIX, ARIZONA
BLM
Date
Stamp

State IL Zip 60439 being duly sworn, depose and say that I am a citizen of the United States, more than eighteen years of age, and that all of the facts set forth in this affidavit, subject to the provisions and penalties of 18 U.S.C. 1001 pertaining to the filing of false, fictitious, or fraudulent statements with the United States, are true and correct according to the best of my knowledge, information and belief.

4. Owner's name and address (If not shown in Items 1-3 above).

5. That I am personally acquainted with the mining claim(s). The work and improvements were made by and at the expense of the owner(s) of said claim(s). Said contiguous group of claims, listed on this document, are situated in the

(optional) Mining District: YAVAPAI County, Arizona.

| Line No. | AMC NUMBER | CLAIM/SITE NAME | COUNTY RECORDER DATA (If available) | TWP | RNG | SEC |
|----------|------------|-----------------|-------------------------------------|-----|-----|-----|
| 1 | 410881 | SILVERSTONE | B 4882 P 905 | 11N | 1W | 2 |
| 2 | 411023 | SILVERSTONE 1 | B 4882 P 906 | 11N | 1W | 2 |
| 3 | 411024 | SILVERSTONE 2 | B 4882 P 907 | 11N | 1W | 2 |
| 4 | 411025 | SILVERSTONE 3 | B 4882 P 908 | 11N | 1W | 2 |
| 5 | 411026 | SILVERSTONE 4 | B 4882 P 909 | 11N | 1W | 2 |
| 6 | 411027 | SILVERSTONE 5 | B 4882 P 910 | 11N | 1W | 2 |

AFFIDAVIT OF PERFORMANCE OF ANNUAL WORK – page 2

RECEIVED
BLM AZ STATE OFFICE
2012 AUG 20 A 10:15
PHOENIX, ARIZONA

BLM
Date
Stamp

| | | | | | | |
|----|--------|---------------|--------------|-----|----|---|
| 7 | 411028 | SILVERSTONE 6 | B 4882 P 911 | 11N | 1W | 2 |
| 8 | 411029 | SILVERSTONE 7 | B 4882 P 912 | 11N | 1W | 2 |
| 9 | | | | | | |
| 10 | | | | | | |

6. That between the dates starting at 12 o'clock noon on September 1, 20 11 and ending at 12 o'clock noon on September 1, 20 12 at least \$ 1000.00 dollars worth of work and improvements were done and performed upon said claim(s) or upon one or more of a contiguous group of claims for the benefit of all, wholly or partly outside of a contiguous group of claims for the benefit of all, not including the location work.

7. That the following persons were employed to perform the work and improvements described herein: PAUL KLABACHA KAREN KLABACHA ED DOMBROWSKI

8. That the work and improvements performed were: ROAD WORK, EXCAVATING, GEOPHYSICAL SURVEYING, PANNING, DETECTING, ECT.

9. Dated: 8-15-2012 Signature: Paul Klabacha

SUBSCRIBED AND SWORN TO before me, a Notary Public, this 15th day of August 20 12

By: Claudia C Rocio

Notary Public Claudia C Rocio

My Commission Expires 04/27/2014

"OFFICIAL SEAL"
Claudia C Rocio
Notary Public, State of Illinois
My Commission Expires 4/27/2014

Bureau of Land Management
Arizona State Office
www.az.blm.gov

No. of Claims: 8 x \$10 = 80.00
Check No.: 2959 Init. AR
Receipt No.: 2635701
For BLM Use Only

Form: MCF108
Revised Jan. 2006
Page 2 of 2



United States Department of the Interior



BUREAU OF LAND MANAGEMENT

Arizona State Office

One North Central Avenue, Suite 800

Phoenix, Arizona 85004-4427

www.blm.gov/az/

May 2, 2012

In Reply Refer To:
3800 (9310) TS
AMC411023

COPY

CERTIFIED MAIL - RETURN RECEIPT REQUESTED No. 7011 2970 0001 8020 6192

NOTICE

PAUL KLABACHA
1 LIMESTONE CT
LEMONT, IL 60439-2102

AMC411025 - AMC411029
SILVERSTONE 3 - 7

RECEIVED
BLM AZ STATE OFFICE
2012 AUG 20 A 10:19
PHOENIX, ARIZONA

Mining Claim Location Notice(s) – Amendment(s) Required

Pursuant to Title 43 Code of Federal Regulations (CFR) 3832.1, this office received your notices of location for recording mining claims. In accordance with 43 CFR 3832.12, the claims listed above cannot be accepted as filed and must be amended as noted below.

Must file an amendment for AMC411025 – AMC411029 (Silverstone 4 – 7). AMC411025, AMC411026, AMC411028 & AMC411029 must reduce the size of the claims down to 1320' X 600'. You have lode dimensions (600' X 1500'). You can't increase the 600' to 660' because you would be taking in new ground. A typical 20 acre placer claim is 660' X 1320', all placer claims should be described by legal land description unless encumbered by private land or other encumbrance i.e. active unpatented mining claims. AMC411027 must reduce down to 1200' X 660'. In this case the claim is encumbered by a patented mining claim and is therefore ok to have the 1200'. All of the claims listed must have the dimensions in feet on the maps.

You must file an amendment for each claim listed above to correct the defects identified. There is a \$10 BLM processing fee for each amendment. We must receive the amendments within 30 days of your receipt of this notice. If the amendments are not received within the 30-day timeframe the mining claims will be declared null and void.

8-15-12

CLAYBACK DEVELOPMENT, LLC

HELLO SUSIE,

FIRST TIME FILLING OUT THESE FORMS,
HOPE I HAVE THEM CORRECT. AMENDED
MY 8 SILVERSTONE CLAIMS IN MAY BY
ORDER OF BLM AND HAD THEM RE-RECORDED.
IF ANY CORRECTIONS NEEDED TO BE MADE
PLEASE CONTACT ME DIRECTLY.

SINCERELY,



312 316-7224

OCK INC @ ATT.NET

DO I NEED TO RECORD THIS ?

RECEIVED
BLM AZ STATE OFFICE
2012 AUG 20 A 10:15
PHOENIX, ARIZONA

CLAYBACK
DEVELOPMENT, LLC

P.O. Box 21 • Lemont, IL 60439

CERTIFIED MAIL™



U.S. POSTAGE
PAID
LEMONT, IL
60439
AUG 16, '12
AMOUNT

\$5.95

00075387-03

7011 2970 0003 0303 0086

1000

85004

BUREAU OF LAND MGMT.

ARIZONA STATE OFFICE

ONE NORTH CENTRAL AVE.

SUITE 800

PHOENIX, ARIZONA 85004-4427

ATTN: SUSIE CRUZ

RETURN RECEIPT
REQUESTED

PHOENIX, ARIZONA

2012 AUG 20 A 10:00

RECEIVED
STATE OFFICE

**CLAYBACK
DEVELOPMENT, LLC**

P.O. Box 21 • Lemont, IL 60439

**RETURN RECEIPT
REQUESTED**

CERTIFIED MAIL™

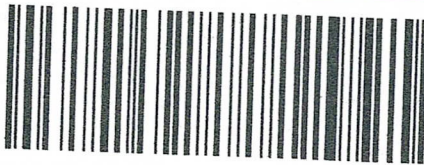

7011 2970 0003 0303 0086

BUREAU OF LAND MGMT.

ARIZONA STATE OFFICE

ONE NORTH CENTRAL AVE

SUITE 800

PHOENIX, ARIZONA 85004-4427

ATTN: SUSIE CRUZ



UNITED STATES
POSTAL SERVICE



1000

85004

PHOENIX, ARIZONA

2012 AUG 20 A 10:00

U.S. POSTAGE
PAID
LEMONT, IL
60439
AUG 16, '12
AMOUNT

\$5.95

00075387-03

RECEIVED
STATE OFFICE

United States Department of the Interior
Bureau of Land Management
 LANDS/RECREATION & PLANNING
 ONE N CENTRAL AVE
 PHOENIX, AZ 85004 -2203
 Phone: 602-417-9200

Receipt

No: 2635701

| | |
|--|--|
| Transaction #: 2716277 | |
| Date of Transaction: 08/21/2012 | |
| CUSTOMER: | |
| PAUL KLABACHA 1 LIMESTONE CT LEMONT,IL 60439-2102 US | |

| LINE # | QTY | DESCRIPTION | REMARKS | UNIT PRICE | TOTAL |
|---------------|------|--|--|------------|----------------|
| 1 | 1.00 | LOCATABLE MINERALS / MINING CLAIMS- NOT NEW-UNADJUD,ONE AUTH NO. ONLY / MINING CLAIM MONEY RECEIVED CASES: AMC410881/\$80.00 | MAINT FEE WAIVER (8) 2013 / POL (8) 2012 | - n/a - | 80.00 |
| TOTAL: | | | | | \$80.00 |

| PAYMENT INFORMATION | | | |
|---------------------|-----------|---|----------------------|
| 1 | AMOUNT: | 80.00 | POSTMARKED: N/A |
| | TYPE: | CHECK | RECEIVED: 08/20/2012 |
| | CHECK NO: | 2959 | |
| | NAME: | CLAYBACK DEVELOPMENT 1 LIMESTONE CT LEMONT IL 60439-2102 US | |

| |
|---------|
| REMARKS |
| |

This receipt was generated by the automated BLM Collections and Billing System and is a paper representation of a portion of the official electronic record contained therein.

NOTICE!!

These documents have been scanned!

Do not place un-scanned documents beneath this notice!

Do not remove this notice from this file!

GPO Jacket No. 560-102
Print Order 61540
Rise Business Services, LLC
Job=AZ15 5/16/2019



Box Number= AZ15055



Claim Begin-End: AMC410881-AMC410881

6 Location Notices-Amendments and Supporting Documents



AZ15055-2 AMC410569-AMC411560

MINING CLAIM STATUS REPORT

DATA ENTERED M

SEP 21 2011

MTP Checked by M

GEO Checked by M

LEAD SERIAL NUMBER

AMC

410881

thru

AMC

OF CLAIMS & TYPE

_____ LODE
 # 1 PLACER
 # _____ ASSOCIATION PLACER
 # _____ MILL SITE
 # _____ TUNNEL SITE

CHARGES

Location Fee @ \$34 = \$ 34
 Processing Fee @ \$15 = \$ 15
 Maintenance Fee @ \$140 = \$ 140.
 Overage (+) \$ _____
 Shortage (-) \$ _____
 Other Fees \$ _____
TOTAL \$ _____

ARE THERE ENOUGH LOCATORS?

Yes () No ()

DOCUMENTS RECEIVED VIA -

Over-the-Counter () Mail ()

TIMELY FILED?

Yes () No ()

LEGAL DESCRIPTION -

| | | | | | |
|---|------------|---|------------|-----|------------|
| T | <u>11N</u> | R | <u>01W</u> | SEC | <u>002</u> |
| T | _____ | R | _____ | SEC | _____ |
| T | _____ | R | _____ | SEC | _____ |
| T | _____ | R | _____ | SEC | _____ |

BLM () FOREST SERVICE () Prescott SUBJ TO PL 359: Yes () No ()

WILDERNESS AREA: No () Yes ()

SPLIT ESTATE - N/A () SX () PX () SRHA () OTHER ()

Proper Notice Filed if Located on SHRA Lands? N/A () Yes () No ()

RECONVEYED MINERALS ON BLM LANDS REQUIRE OPENING ORDERS FROM 1944 TO 1993 -

Open to Entry on: _____ N/A ()

COMMENTS/STATUS - VOID () PARTIALLY VOID () PVT MINERALS () WITHDRAWN LANDS ()
OTHER () _____

Claimant acknowledges that portions of the following claims(s) site(s) may be void or voidable.

Printed Name of Claimant _____

Signature of Claimant _____

***** FINAL ADJUDICATION *****

DATE 4/9/2012

INITIALS TS

AMC 410881

United States Department of the Interior
Bureau of Land Management
 LANDS/RECREATION & PLANNING
 ONE N CENTRAL AVE
 PHOENIX, AZ 85004 -2203
 Phone: 602-417-9200

Receipt

No: 2575100

| | |
|--|--|
| Transaction #: 2654579 | |
| Date of Transaction: 05/24/2012 | |
| CUSTOMER: | |
| PAUL KLABACHA 1 LIMESTONE CT LEMONT,IL 60439-2102 US | |

| LINE # | QTY | DESCRIPTION | REMARKS | UNIT PRICE | TOTAL |
|---------------|------|--|----------------|------------|----------------|
| 1 | 1.00 | LOCATABLE MINERALS / MINING CLAIMS-NOT NEW-UNADJUD,ONE AUTH NO. ONLY / MINING CLAIM MONEY RECEIVED CASES: AMC410881/\$80.00 | AMENDMENTS (8) | - n/a - | 80.00 |
| TOTAL: | | | | | \$80.00 |

| PAYMENT INFORMATION | | | | | |
|---------------------|-----------|---|-------------|------------|--|
| 1 | AMOUNT: | 80.00 | POSTMARKED: | 05/19/2012 | |
| | TYPE: | CHECK | RECEIVED: | 05/24/2012 | |
| | CHECK NO: | 8146 | | | |
| | NAME: | OCK ELECTRIC INC 1 LIMESTONE CT LEMONT IL 60439-2102 US | | | |

| |
|---------|
| REMARKS |
| |

This receipt was generated by the automated BLM Collections and Billing System and is a paper representation of a portion of the official electronic record contained therein.

AMC 410881

PAUL KLABACHA 'SILVERSTONE' AMC 410881 AMENDMENT

LOCATION NOTICE FOR PLACER MINING CLAIM

NOTICE IS HEREBY GIVEN that the SILVERSTONE

_____ placer mining claim has been located by

PAUL KLABACHA whose current mailing

address is 1 LIMESTONE CT,

LEMONT IL 60439

BLM
Date
Stamp

RECEIVED
BLM ARIZONA OFFICE
2012 MAY 21 PM 3:00
PIQUEUR, ARIZONA

The general course of this claim is EAST AND WEST and it is situated in

YAVAPAI County, Arizona.

This claim is 1400 feet in length and 600 feet in width. This claim runs from the

location monument on which this location notice is posted approximately 1350 feet in a WESTERLY

direction to the WEST end line and 50 feet in a EAST direction to the EASTERN end line.

This claim is marked by four monuments, one at each corner of the claim.

The location monument on which this notice is posted is situated within Section 2, Township

11 N, Range 1 W, Gila Salt River Base and Meridian, Arizona. This claim encompasses

portions of the following legal subdivision(s) if located by legal subdivision or the following quarter section (s),

section (s), Township (s) and Range (s) NW NE SW SE

SC2-TWIN-RG1W, Gila Salt River Base and Meridian, Arizona.

The locality of this claim with reference to some natural object or permanent monument and additional information (if any) concerning its locality are as follows: 2" P.V.C.

DATED AND POSTED on the ground this 18 day of SEPT, 20 11

LOCATOR (s) Paul Klabacha

PAUL KLABACHA

Form MCF102
Revised July 2005

MINING CLAIM MAP

Lode () Placer (X)

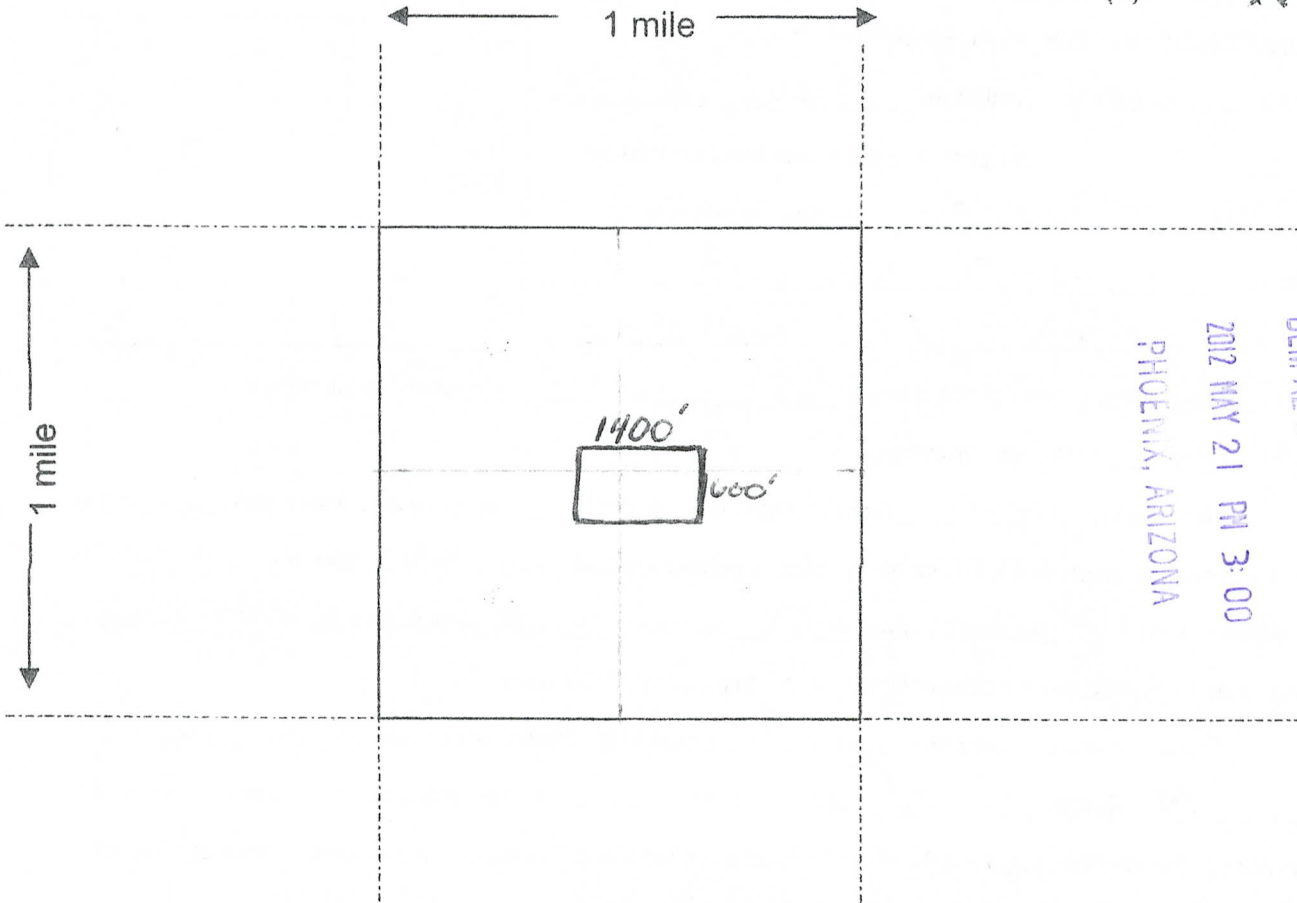

RECEIVED
 BLM AZ STATE OFFICE
 2012 MAY 21 PM 3:00
 PHOENIX, ARIZONA

Scale : 1" = 2000 feet



1. The above map depicts the SILVERSTONE mining claim, which is located in Section (s) 2, Township 11 N, Range 1 W, Gila and Salt River Base and Meridian, YAVAPAI County, Arizona.

2. The type of corner and location monuments used are as follows: 2" P.V.C.

3. The bearings and distances in degrees and feet between claim corners are as depicted on the map.

Form MCF100a
 Revised July 2005

LOCATION NOTICE FOR PLACER MINING CLAIM

NOTICE IS HEREBY GIVEN that the SILVERSTONE
_____ placer mining claim has been located by
PAUL KLABACHA whose current mailing
address is 1 LIMESTONE CT.
LEWYONT IL 60439

RECEIVED
BLM, AZ STATE OFFICE
2011 SEP 19 A 11:36
PHOENIX, AZ
BLM
Date
Stamp

The general course of this claim is EAST AND WEST and it is situated in
YAVAPAI County, Arizona.

This claim is 1500 feet in length and 600 feet in width. This claim runs from the
location monument on which this location notice is posted approximately 1500 feet in a WESTERN
direction to the WEST end line and 50 feet in a EAST direction to the EASTERN end line.
This claim is marked by four monuments, one at each corner of the claim.

The location monument on which this notice is posted is situated within Section 2, Township
11 N, Range 1 W, Gila Salt River Base and Meridian, Arizona. This claim encompasses
portions of the following legal subdivision(s) if located by legal subdivision or the following quarter section (s),
section (s), Township (s) and Range (s) _____
SEC 2 T11N R1W, Gila Salt River Base and Meridian, Arizona.

The locality of this claim with reference to some natural object or permanent monument and additional
information (if any) concerning its locality are as follows: 2" PVC

DATED AND POSTED on the ground this 18 day of SEPT, 2011
LOCATOR (s) NE NW SE Paul Klabacha

Form MCF102
Revised July 2005

AMC410881

MINING CLAIM MAP

Lode () Placer ()

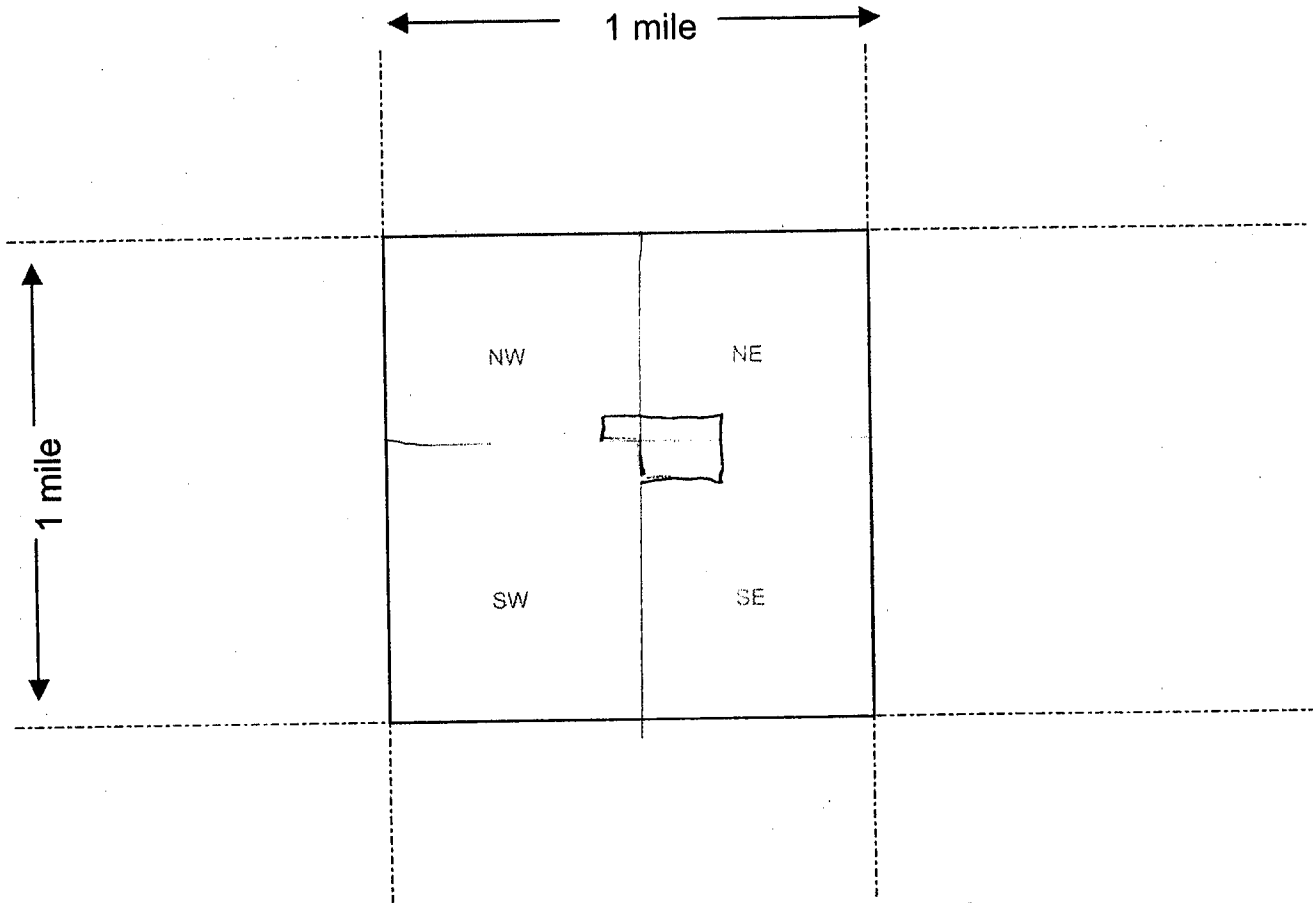

Scale : 1" = 2000 feet



1. The above map depicts the SILVERSTONE mining claim, which is located in Section (s) 2, Township 11 N, Range 1 W, Gila and Salt River Base and Meridian, _____ County, Arizona.
2. The type of corner and location monuments used are as follows: 2" PVC
3. The bearings and distances in degrees and feet between claim corners are as depicted on the map.

Form MCF100a
Revised July 2005

RUN TIME: 11:30 AM

Adm State:

UNITED STATES DEPARTMENT OF INTERIOR
BUREAU OF LAND MANAGEMENT
GEOGRAPHIC REPORT WITH LAND
Sorted by Meridian Township Range

RUN DATE: 09/21/2011
Page 1 of 1

Input Parameters for Geographic Report with Land

System Id = CR

Admin State = AZ

Geo State =

Casetype Begins With

Case Disp Txt = AUTHORIZED, CANCELLED, EXPIRED, PENDING, REJECTED, RELINQUISHED, WITHDRAWN

Mer Twp Rng =

Section =

Mtrs = 14 0110N 0010W 002, 14 0110N 0010W 999

Commodity =

Commodity Txt =

Pending Org =

Pend Org Decode =

Total Rows Returned: 0

